

● BS Arch – 3rd Year & 4th Year

● L Arch – 3rd Year

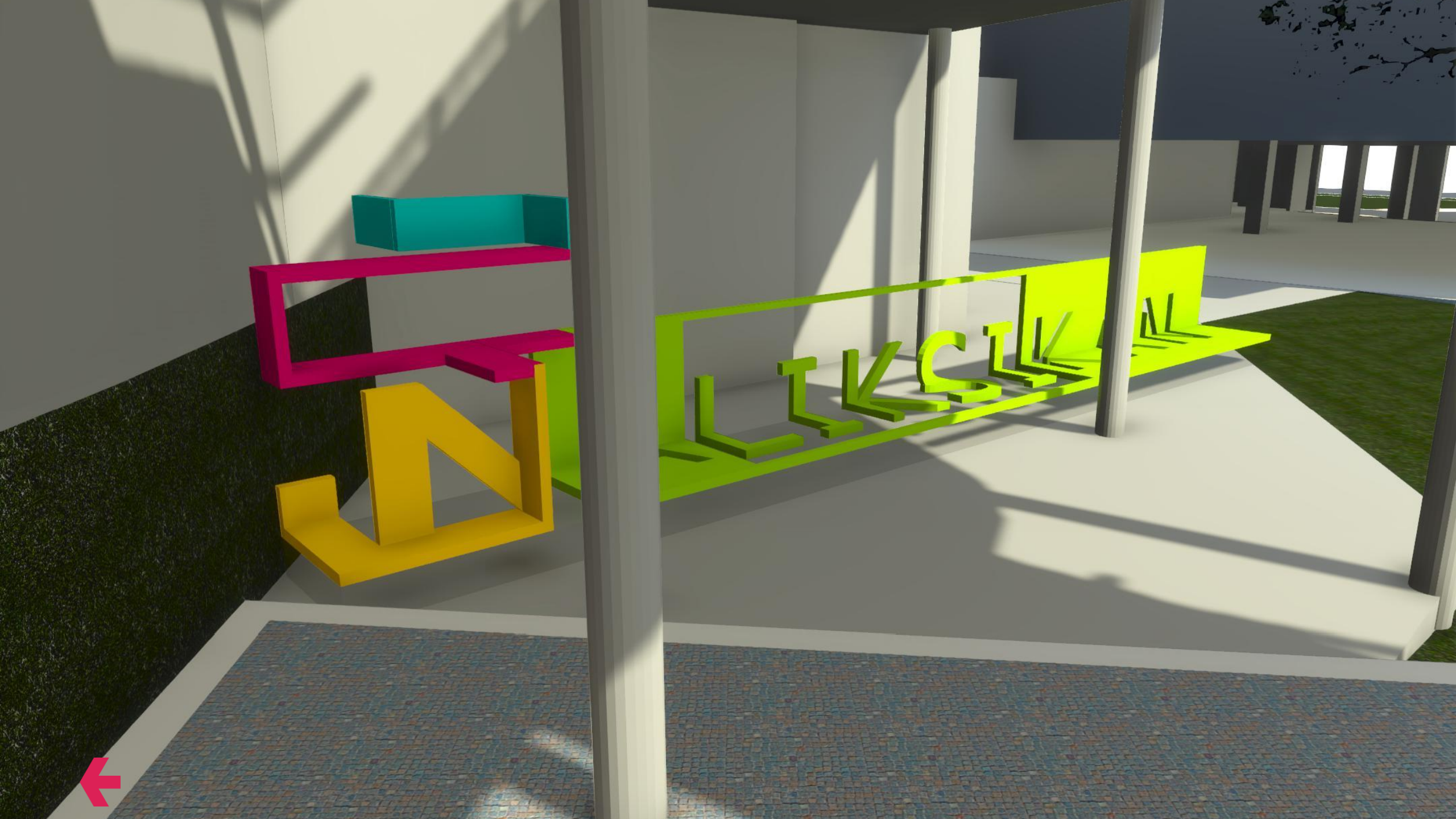

ALIKSIKAN





FLOOR DIRECTORY OF DISPLAYS

Building 1

LOWER GROUND

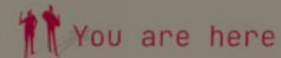

SECOND FLOOR

- BS Architecture
 - 5 Arch 199.2: Thesis
- B Landscape Architecture
 - 4 L Arch 199.2: Thesis
 - 4 L Arch 200: Thesis

Building 2

UPPER GROUND

- BS Architecture
 - 1 Arch 3: Advanced Rendering and Graphic Layout
- B Landscape Architecture
 - 1 L Arch 12: Community Park
- CWTS
 - CWTS 2: Community Proposal

LOWER GROUND

- BS Architecture
 - Arch 5: High-End Two-Storey Residential Project
 - Arch 22: Maginhawa Landmark Hub
 - 2 Arch 22: UP Diliman Students' Wellness Center
- B Landscape Architecture
 - 2 L Arch 22: Kalinga Daycare Center

Bridge Area

- M Architecture
 - Arch 380: Thesis
- PhD Designed and Built Environment
 - DSE 397
- MA in Architecture Studies
 - Arch1 299





Arch 142: *Metropolitan Architecture*

Arch 143: *Lighting*

Arch 171: *Banana Crane*

Arch 32: *Multi-family Housing Project*

Arch 31: *UP Shopping Center*

Arch 162: *Metropolitan Structure*

Arch 147: *Acoustics*





● L Arch 132: Protected Area
Landscape Design

● L Arch 132: Botanical Park
Landscape Design

● L Arch 132: Mini - thesis

● L Arch 132: Protected Area Management
Through GIS Technologies

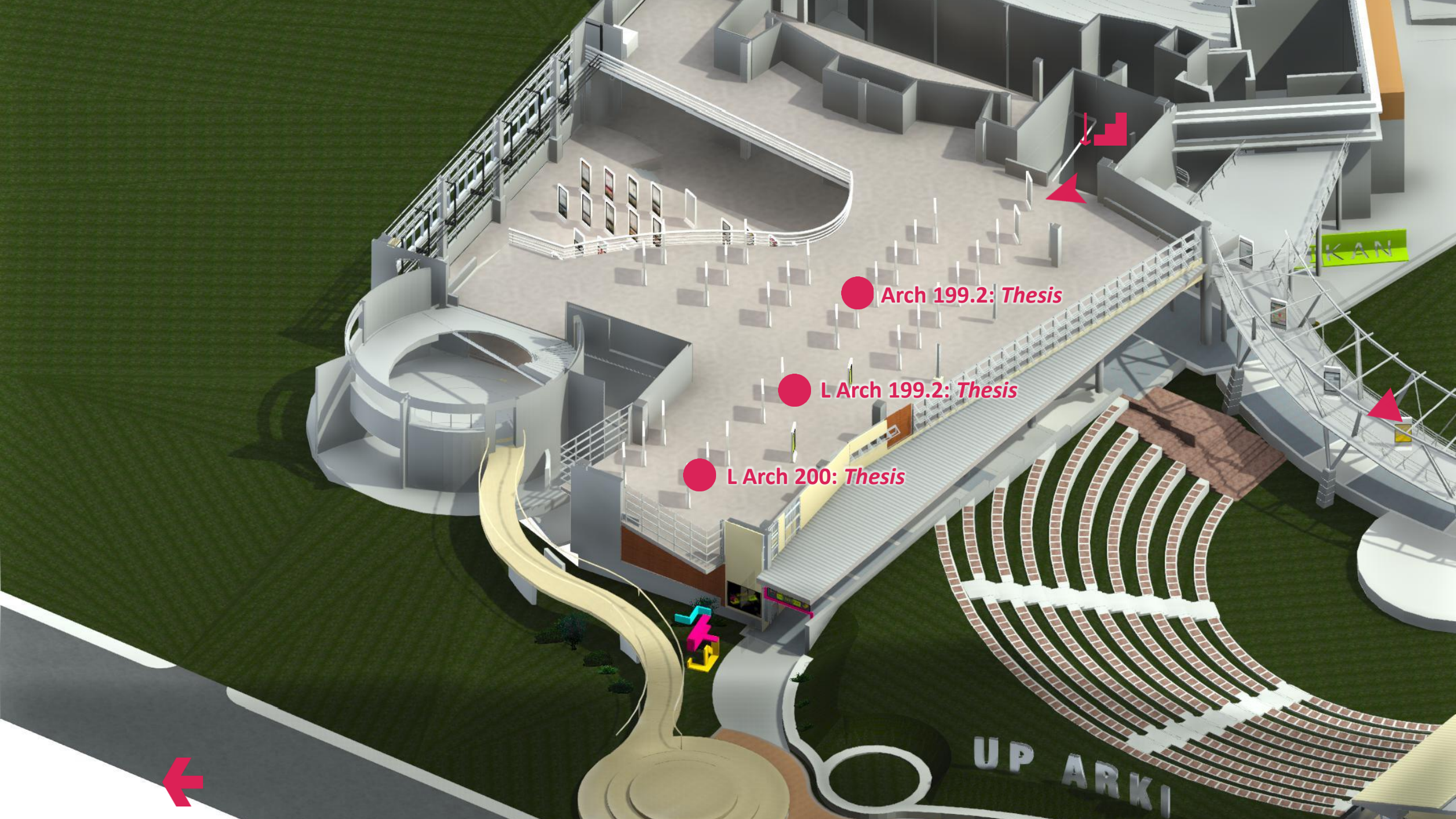

Arch 199.2: Thesis

L Arch 199.2: Thesis

L Arch 200: Thesis

UP ARKI



FLOOR DIRECTORY OF DISPLAYS

Building 1

LOWER GROUND

● BS Architecture

Arch 31: UP Shopping Center

Arch 32: Multi-family Housing Project

Arch 171: Banana Crane

Arch 142: Metropolitan Architecture

Arch 143: Acoustics

Arch 147: Lighting

Arch 162: Metropolitan Structure Plans and Vision Boards

● B Landscape Architecture

L Arch 132: Protected Area Landscape Design

L Arch 132: Botanical Park Landscape Design

L Arch 132: Mini-Thesis

L Arch 138: Protected Area Management through GIS Technologies

SECOND FLOOR

You are here



Building 2

UPPER GROUND

● BS Architecture

Arch 3: Advanced Rendering and Graphic Layout

● B Landscape Architecture

L Arch 12: Community Park

● CWTS

CWTS 2: Community Proposal

LOWER GROUND

● BS Architecture

Arch 5: High-End Two-Storey Residential Project

Arch 22: Maginhawa Landmark Hub

Arch 22: UP Diliman Students' Wellness Center

● B Landscape Architecture

L Arch 22: Kalinga Daycare Center

Bridge Area

● M Architecture

Arch 388: Thesis

● PhD Designed and Built Environment

DBE 397

● MA in Architecture Studies

Archi 299







BS ARCHIT
3RD YEAR
Arch 32:
Multi-Family
Project

BS ARCHITECTURE
3RD YEAR

Arch 31:
Up Shopping Center



BS ARCHITECTURE
4TH YEAR



ECTURE
Houston

SENTRO

THE REMAGINED SHOPPING CENTER

This presentation board for 'SENTRO' is a vertical collage of architectural information. At the top, it features a photograph of a modern building facade. Below this are several diagrams, including a site plan and conceptual diagrams showing the layout and design of the shopping center. The middle section contains numerous small images and diagrams, likely representing material samples or design details. At the bottom, there is a large architectural rendering of the completed shopping center, with the text 'THE REMAGINED SHOPPING CENTER' and 'SENTRO' overlaid.

THE UP BOARDWALK

GINO BALDO & ALYSSA SANTANA

This presentation board for 'THE UP BOARDWALK' is a vertical collage of architectural information. At the top, it features a photograph of a modern building facade. Below this are several diagrams, including a site plan and conceptual diagrams showing the layout and design of the building. The middle section contains numerous small images and diagrams, likely representing material samples or design details. At the bottom, there is a large architectural rendering of the completed building, with the text 'THE UP BOARDWALK' and 'GINO BALDO & ALYSSA SANTANA' overlaid.



CROSSROADS
A PROPOSED NEW UP-SHOPPING CENTER

CONCEPT

SITE DEVELOPMENT PLAN SECOND FLOOR PLAN

ZONING

SECTION AND ELEVATIONS

PERSPECTIVES

LEASABLE SPACE SETUPS

PROJECT 01 : REIMAGINED SC

SITE DEVELOPMENT PLAN

SECTION AND ELEVATIONS

PERSPECTIVES

PROJECT 01 REIMAGINED SC



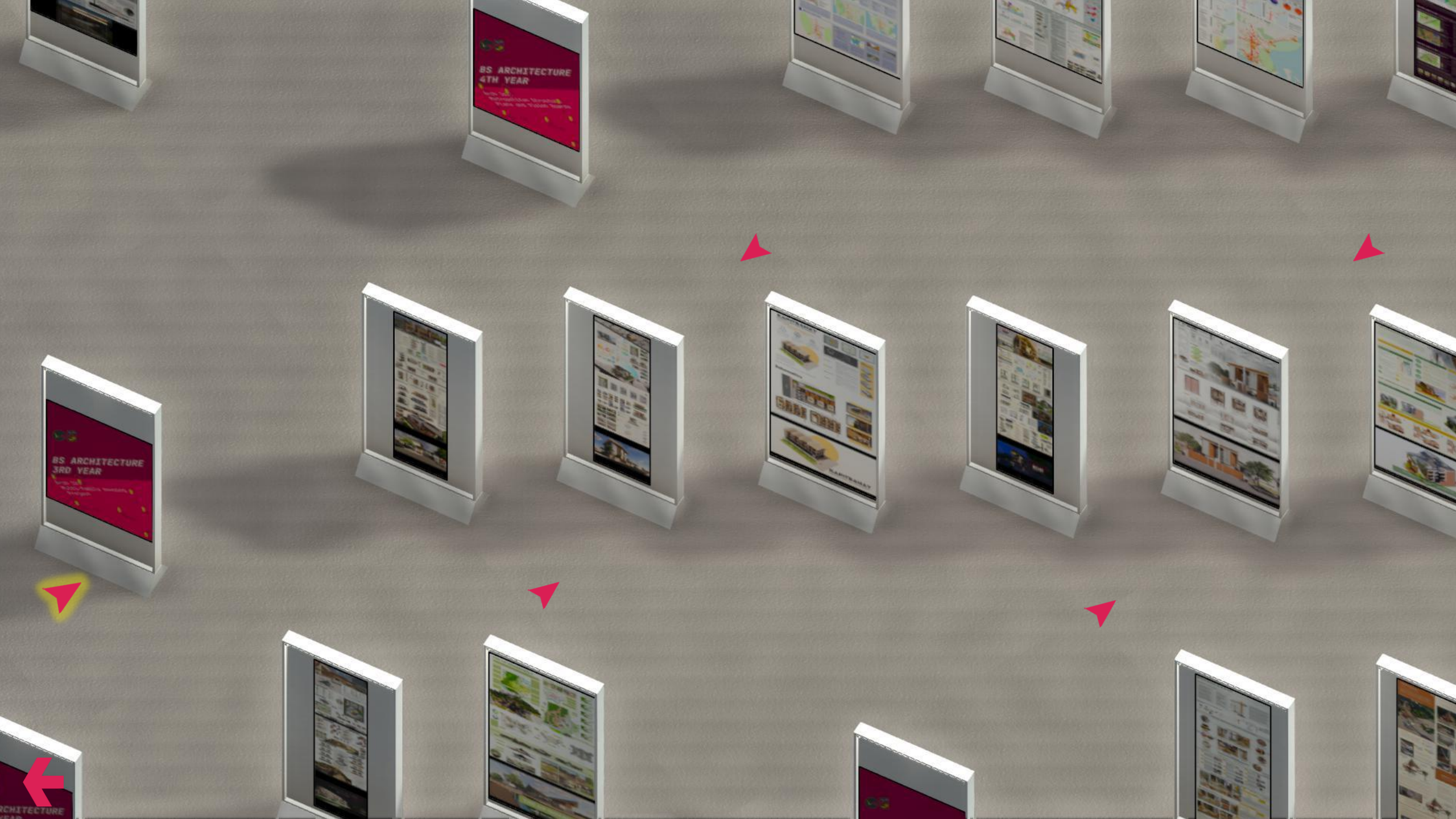



BS ARCHITECTURE
3RD YEAR

Arch 32:
Multi-family Housing
Project

The poster features a dark red background with a lighter red diagonal section at the bottom. It includes a logo with stylized letters 'L' and 'G' in green and yellow. The text is in white, bold, sans-serif font. The bottom section contains several small, colorful circular icons.



BS ARCHITECTURE
4TH YEAR

Arch 365:
Metropolitan Structures
Plans and Vision Book-its

This poster is similar in style to the 3rd year one, with a red background and white text. It features the same logo and a title for a 4th-year project.



A tall, vertical white board displaying a comprehensive architectural portfolio. It includes a 3D rendering of a building at the top, followed by various diagrams, site plans, and smaller images of architectural models and drawings. The bottom section features a photograph of a building with the text "SILANG LOWNHOUSES" below it.



A tall, vertical white board displaying architectural work. It features a 3D rendering of a building at the top, followed by diagrams and smaller images. The bottom section shows a photograph of a building.



KAPITBAHAY

Architectural portfolio board featuring a 3D rendering of a building and the title "KAPITBAHAY". It includes diagrams and smaller images of architectural models.



Architectural portfolio board displaying a 3D rendering of a building and various architectural diagrams and images.



SILANG TOWNHOMES

ARCHITECTURE

5TH YEAR

Arch 162, Metropolitan Structuring Plans and Vision Boards

SILANG TOWNHOMES

Multifamily Housing Project

KAPITBAHAY
BUILDING A FAMILY WITH THE COMMUNITY

DESIGN CONCEPT
"DEVELOPMENT THROUGH SOCIAL ECOLOGICAL THEORY"

SITE ANALYSIS

SCHEMATICS

SITE DEVELOPMENT PLAN

PRO FLOOR PLAN OF BUILDING

1ST FLOOR PLAN OF BUILDING

KAPITBAHAY
BUILDING A FAMILY WITH THE COMMUNITY

Project to ROOF

is a sign of progress



TALARO

Architectural Firm



THE GREENWAY HOUSE

Multi-family Housing Project

Site Zoning and Information

Design Approach

Design Collage and Form

Site Analysis

Space Programming

Floor Plans



KAIROS RESIDENCES

COMMUNITY AND ENVIRONMENTAL CONTEXT

DESIGN APPROACH - CONCEPTS

DESIGN TRANSLATION

GROUND FLOOR PLAN ON SITE

TYPICAL UNIT FLOOR PLAN

SECOND FLOOR PLAN

THIRD FLOOR PLAN

INTERIOR PERSPECTIVES

Architectural presentation board for 'KAIROS RESIDENCES'. The board is divided into several sections: 'SITE CONTEXT' with a site map, 'COMMUNITY AND ENVIRONMENTAL CONTEXT' with descriptive text, 'DESIGN APPROACH - CONCEPTS' with diagrams, 'DESIGN TRANSLATION' with material and color swatches, 'GROUND FLOOR PLAN ON SITE' with a site plan, 'TYPICAL UNIT FLOOR PLAN' with a unit layout, 'SECOND FLOOR PLAN' and 'THIRD FLOOR PLAN' with additional unit layouts, and 'INTERIOR PERSPECTIVES' with small images of interior spaces. A large photograph of the building facade is at the bottom. A pink arrow points left from the left edge.

THE COURTYARD HOUSE

DESIGN APPROACH - CONCEPTS

PLANS AND ELEVATIONS

Architectural presentation board for 'THE COURTYARD HOUSE'. The top section is titled 'DESIGN APPROACH - CONCEPTS' and features a diagram of a courtyard layout and a list of four numbered points (01-04). Below this is a section titled 'PLANS AND ELEVATIONS' showing architectural drawings. The bottom half of the board is dominated by a large, high-quality photograph of the building's exterior, with the title 'THE COURTYARD HOUSE' overlaid in white text. A pink arrow points left from the left edge.

paghābi

A multi-family dwelling project

Architectural presentation board for 'paghābi'. The board is a dense grid of various architectural drawings, including site plans, floor plans, elevations, and interior renderings. At the bottom, there is a large photograph of the building facade with the title 'paghābi' and the subtitle 'A multi-family dwelling project'. A pink arrow points right from the right edge.

APERTURE

Architectural presentation board for 'APERTURE'. The board features a large image of a building facade at the top. Below it are several sections: 'DESIGN PROBLEM', 'DESIGN CONCEPTS & TRANSLATIONS', 'SITE ANALYSIS', 'DESIGN APPROACH', and 'BUILDING PLANS'. The board is framed in white and has a white base.

GINHAWA

Religiosity Project for
Luzon & Mindanao, October 2014

Architectural presentation board for 'GINHAWA'. The board features a large image of a building facade at the top. Below it are several sections: 'DESIGN PROBLEM', 'DESIGN CONCEPTS & TRANSLATIONS', 'SITE ANALYSIS', 'SWOT ANALYSIS', 'DESIGN APPROACH', and 'BUILDING PLANS AND EXTERIOR PERSPECTIVES'. The board is framed in white and has a white base.



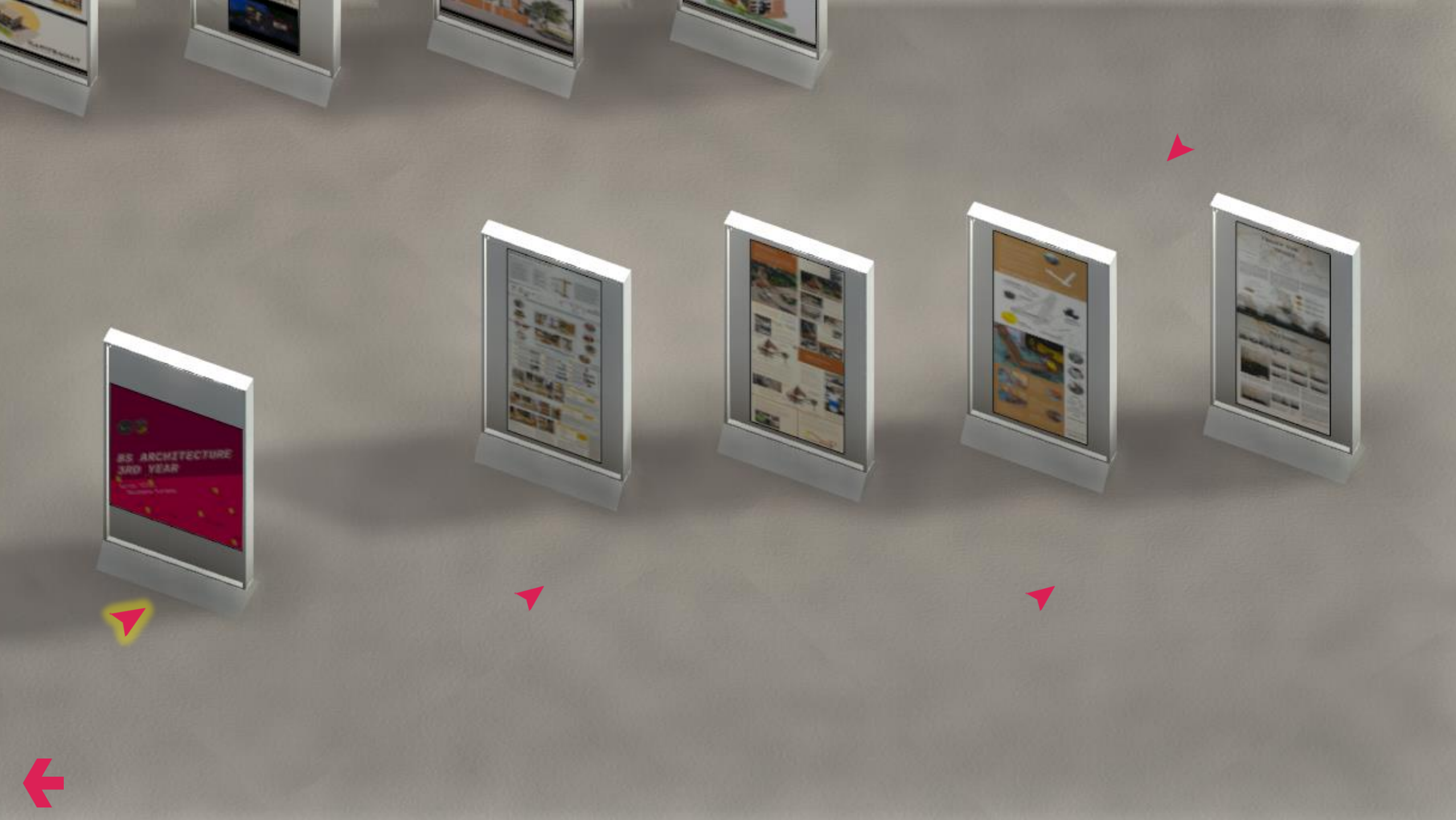

BS ARCHITECTURE
3RD YEAR
Arch 171
Banana Crane

The poster features a dark red background with a diagonal split. The top half is a darker red, and the bottom half is a lighter red. It includes two circular logos with stylized letters 'L' and 'G' in green and yellow. The text is in white, bold, sans-serif font. There are several small, colorful circular icons scattered at the bottom of the poster.

This poster provides a general overview of the project, including architectural drawings, photographs of the structure, and descriptive text. It is part of a series of informational displays.

BANANA CRANE

DEMO CONCEPT

PRELIMINARY RESEARCH

FINAL BANANA CRANE FEATURES

CONSTRUCTION

LOAD TESTING

RESULTS OF LOAD TESTING

This poster details the design and construction of the crane. It features a central diagram of the crane's mechanism, surrounded by smaller images and text blocks. The title 'BANANA CRANE' is prominently displayed at the top.

BANANA STAND

CONSTRUCTION

LOAD TESTING

RESULTS OF LOAD TESTING

This poster focuses on the construction and testing of the crane's stand. It includes detailed diagrams of the stand's structure and photographs of the construction process.

TRUST THE TRUSS

LOAD TESTING

RESULTS OF LOAD TESTING

This poster discusses the truss structure used in the crane. It features diagrams of the truss and images of the testing process.

TRUST THE TRUSS

LOAD TESTING

RESULTS OF LOAD TESTING

This poster continues the discussion on the truss structure, providing further details on its design and performance.



BANANA CRANE

DESIGN CONCEPT - BALANCE - FORM

The final product has both utility and aesthetic appeal. It is designed to be a functional piece of furniture that is also a work of art. The design concept is based on the idea of a crane, which is a structure used for lifting heavy loads. The crane is made of wood and is designed to be a functional piece of furniture that is also a work of art. The design concept is based on the idea of a crane, which is a structure used for lifting heavy loads. The crane is made of wood and is designed to be a functional piece of furniture that is also a work of art.



PRELIMINARY SCHEMATIC DESIGN



FINAL SCHEMATIC ELEVATION DIMENSIONS

FINAL BANANA CRANE FEATURES



MATERIALS

- 1. Plywood
- 2. Bamboo
- 3. Rope
- 4. Canvas

PROCEDURE

1. Design and create the crane structure.
2. Test the crane structure for stability and load capacity.
3. Refine the design based on test results.
4. Finalize the design and create the final product.

LOAD TESTING RESULTS & OBSERVATIONS

Supporting one hand of bananas
Weight of bananas: 10kg
Observation: The crane structure is stable and can support the weight of the bananas.

Weight of initial deformation & rupture
Weight of bananas: 15kg
Observation: The crane structure shows initial deformation and rupture at the joints.

Weight of prototype collapse
Weight of bananas: 20kg
Observation: The crane structure collapses under the weight of the bananas.

HMS Banana

The HMS Banana is a functional piece of furniture that is also a work of art. It is designed to be a functional piece of furniture that is also a work of art. The design concept is based on the idea of a crane, which is a structure used for lifting heavy loads. The crane is made of wood and is designed to be a functional piece of furniture that is also a work of art.



CONCEPT

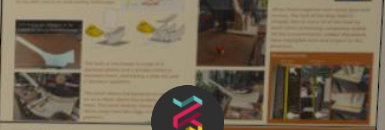

HMS BANANA LOAD TESTING



CONCLUSION

The HMS Banana is a functional piece of furniture that is also a work of art. It is designed to be a functional piece of furniture that is also a work of art. The design concept is based on the idea of a crane, which is a structure used for lifting heavy loads. The crane is made of wood and is designed to be a functional piece of furniture that is also a work of art.

BANANA STAND



BANANA STAND

CONCEPT

The goal of this project was to create a stand for a banana stand that is both functional and aesthetically pleasing. The stand is made of bamboo and is designed to be portable and easy to use.

COMPOSITE MEMBER

Used for the main structure of the stand, this member is made of bamboo and is reinforced with a composite material for added strength.

WINDHOLE

Used to allow air to flow through the stand, this member is made of bamboo and is reinforced with a composite material for added strength.

COUNTERWEIGHT

Used to balance the stand, this member is made of bamboo and is reinforced with a composite material for added strength.

AXIS

Used to support the stand, this member is made of bamboo and is reinforced with a composite material for added strength.

AXIS SPOT VIEW

SECTION SPOT VIEW

PORTABLE FORM

WEIGHTS

Weight	1.500
Material	Bamboo
Construction	Handmade
Location	University of Applied Sciences

EFFICIENCY

Efficiency of the stand is 31%.

FREE BODY DIAGRAM

Free body diagram showing the forces acting on the stand.

25.90 N M

TRUST THE TRUSS

TRUSS

The truss is a structural member that is used to support a load. It is made of bamboo and is designed to be portable and easy to use.

PROTOTYPE AND LOAD WEIGHING

LOAD TESTING

PHYSICAL DAMAGE

THE GREENWAY HOUSE

CONCEPT

The goal of this project was to create a house that is both functional and aesthetically pleasing. The house is made of bamboo and is designed to be portable and easy to use.

CONCEPT

The goal of this project was to create a house that is both functional and aesthetically pleasing. The house is made of bamboo and is designed to be portable and easy to use.

CONCEPT

The goal of this project was to create a house that is both functional and aesthetically pleasing. The house is made of bamboo and is designed to be portable and easy to use.

CONCEPT

The goal of this project was to create a house that is both functional and aesthetically pleasing. The house is made of bamboo and is designed to be portable and easy to use.

CONCEPT

The goal of this project was to create a house that is both functional and aesthetically pleasing. The house is made of bamboo and is designed to be portable and easy to use.

ARCH 171 BANANA SPLIT
 ARCHITECTURAL ARCHITECTURE
 ARCHITECT: JAMES DANIEL
 100% BELGA

BANANA SPLIT
 ARCHITECTURAL ARCHITECTURE
 ARCHITECT: JAMES DANIEL
 100% BELGA

PROBLEM STATEMENT
 The challenge was to design a structure that could support a load of 100kg and stand for 24 hours. The structure had to be made of wood and had to be as simple as possible.

PROPOSED SOLUTION
 The proposed solution was a simple truss structure. It was made of wood and had a central vertical post. The structure was supported by four legs. The legs were made of wood and were connected to the central post by diagonal bracing.

CONSTRUCTION
 The construction was done in three stages. First, the legs were made. Then, the central post was made. Finally, the diagonal bracing was added.

TESTING
 The structure was tested by placing a load of 100kg on top. It was able to support the load for 24 hours without any problems.

CONCLUSIONS
 The structure was able to support a load of 100kg and stand for 24 hours. This was due to the simple truss design and the use of wood.

FRONT ELEVATION
 FRONT ELEVATION
 FRONT ELEVATION

ARCH 171 BANANA SPLIT
 ARCHITECTURAL ARCHITECTURE
 ARCHITECT: JAMES DANIEL
 100% BELGA

BANANA SPLIT
 ARCHITECTURAL ARCHITECTURE
 ARCHITECT: JAMES DANIEL
 100% BELGA

PROBLEM STATEMENT
 The challenge was to design a structure that could support a load of 100kg and stand for 24 hours. The structure had to be made of wood and had to be as simple as possible.

PROPOSED SOLUTION
 The proposed solution was a simple truss structure. It was made of wood and had a central vertical post. The structure was supported by four legs. The legs were made of wood and were connected to the central post by diagonal bracing.

CONSTRUCTION
 The construction was done in three stages. First, the legs were made. Then, the central post was made. Finally, the diagonal bracing was added.

TESTING
 The structure was tested by placing a load of 100kg on top. It was able to support the load for 24 hours without any problems.

CONCLUSIONS
 The structure was able to support a load of 100kg and stand for 24 hours. This was due to the simple truss design and the use of wood.

FRONT ELEVATION
 FRONT ELEVATION
 FRONT ELEVATION

ARCH 171 BANANA SPLIT
 ARCHITECTURAL ARCHITECTURE
 ARCHITECT: JAMES DANIEL
 100% BELGA

BANANA SPLIT
 ARCHITECTURAL ARCHITECTURE
 ARCHITECT: JAMES DANIEL
 100% BELGA

PROBLEM STATEMENT
 The challenge was to design a structure that could support a load of 100kg and stand for 24 hours. The structure had to be made of wood and had to be as simple as possible.

PROPOSED SOLUTION
 The proposed solution was a simple truss structure. It was made of wood and had a central vertical post. The structure was supported by four legs. The legs were made of wood and were connected to the central post by diagonal bracing.

CONSTRUCTION
 The construction was done in three stages. First, the legs were made. Then, the central post was made. Finally, the diagonal bracing was added.

TESTING
 The structure was tested by placing a load of 100kg on top. It was able to support the load for 24 hours without any problems.

CONCLUSIONS
 The structure was able to support a load of 100kg and stand for 24 hours. This was due to the simple truss design and the use of wood.

FRONT ELEVATION
 FRONT ELEVATION
 FRONT ELEVATION

Banana Split!
 ARCH 171 BANANA SPLIT
 ARCHITECT: JAMES DANIEL
 100% BELGA

PROBLEM STATEMENT
 The challenge was to design a structure that could support a load of 100kg and stand for 24 hours. The structure had to be made of wood and had to be as simple as possible.

PROPOSED SOLUTION
 The proposed solution was a simple truss structure. It was made of wood and had a central vertical post. The structure was supported by four legs. The legs were made of wood and were connected to the central post by diagonal bracing.

CONSTRUCTION
 The construction was done in three stages. First, the legs were made. Then, the central post was made. Finally, the diagonal bracing was added.

TESTING
 The structure was tested by placing a load of 100kg on top. It was able to support the load for 24 hours without any problems.

CONCLUSIONS
 The structure was able to support a load of 100kg and stand for 24 hours. This was due to the simple truss design and the use of wood.

FRONT ELEVATION
 FRONT ELEVATION
 FRONT ELEVATION





BS ARCHITECTURE 4TH YEAR



Arch 147
Acoustics



Architectural drawings for an auditorium design. The top section shows multiple interior perspective views of the auditorium seating and stage area. Below these are two detailed floor plans: the 'GENERAL FLOOR PLAN' and the 'AUDITORIUM FLOOR PLAN'. The middle section features two longitudinal sections, labeled 'LONGITUDINAL SECTION 1' and 'LONGITUDINAL SECTION 2'. The bottom section includes a 'SECTIONAL ELEVATION' and a 'SECTIONAL ELEVATION 2', along with a 'SECTIONAL ELEVATION 3' and a 'SECTIONAL ELEVATION 4'. A small circular logo with a stylized 'S' and 'A' is visible on the page.

Architectural drawings for an auditorium design. The top left features an exterior rendering of the building with the title 'AUDITORIUM DESIGN' and the location 'AUN 127, Ampang, Tristari'. To the right is a 'SITE DEVELOPMENT PLAN'. Below the rendering is a 'LONGITUDINAL SECT.' and to its right is an 'AUDITORIUM & BALCONY PLAN - RAY TRACING'. The middle section shows an 'INTERIOR REFLECTED CEILING PLAN' and an 'AUDITORIUM LONGITUDINAL SECTION - RAY TRACING'. The bottom section contains a 'COMPARISON OF REAL ENERGY CONSUMPTION, TOTAL REVENUE, AND OTHERS AND OTHERS' table. A small circular logo with a stylized 'S' and 'A' is visible on the page.



PERSPECTIVES

AUDITORIUM DESIGN

FLOOR PLAN

CEILING PLAN AND SECTION

ACOUSTIC DESIGN

ACOUSTIC DIAGRAM

WALL BY SECTION

MATERIAL SPECIFICATIONS AND CALCULATIONS

RIPPLE



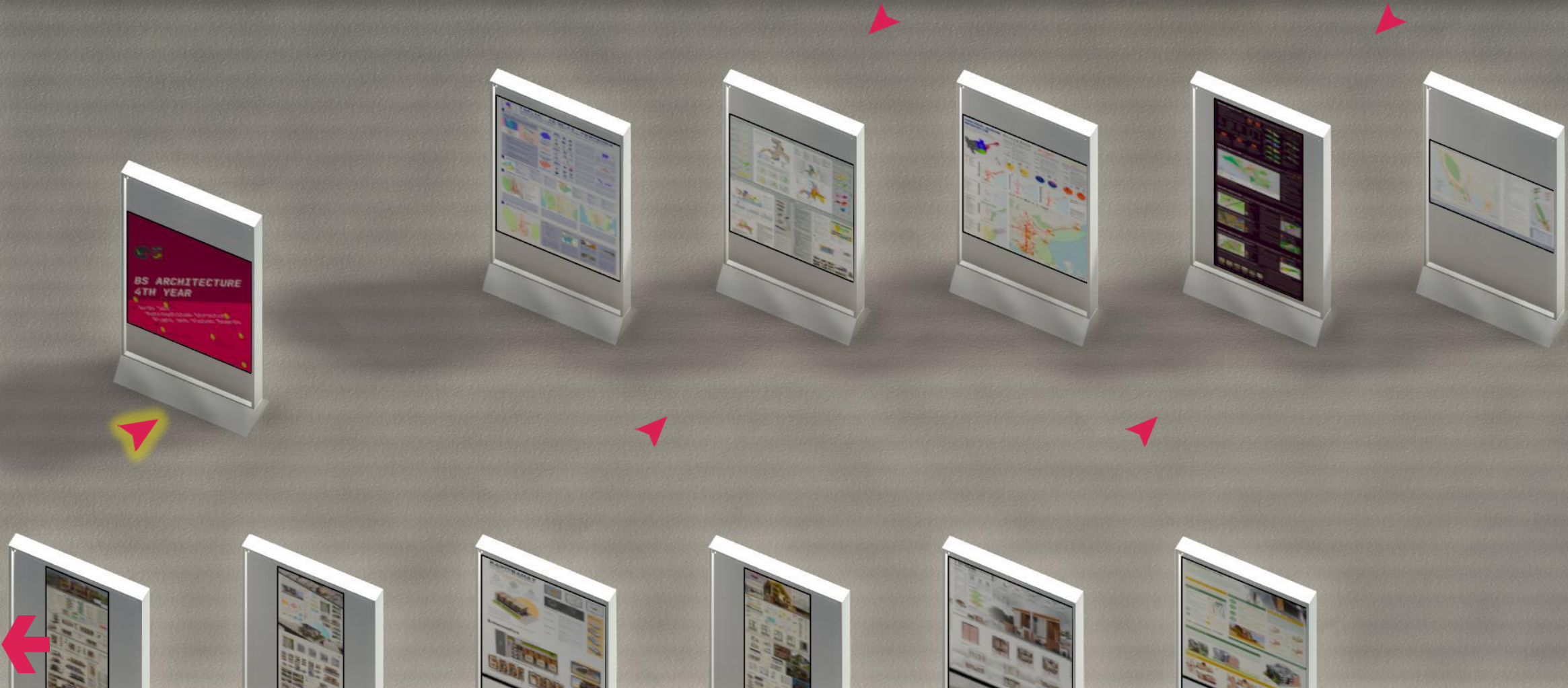



BS ARCHITECTURE 4TH YEAR

Arch 162:
Metropolitan Structure,
Plans and Vision Boards



TARLAC - ANGELES - PAMPANGA

BACKGROUND RESEARCH, ISOSTATO MAP & METRO MATRIX

TAP OVERVIEW

ISOSTATO MAP

METRO MATRIX

METRO BATANGAS PLAN

CENTRAL LUZON: Nueva Ecija REGION III



B LANDSCAPE ARCHITECTURE YEAR

TARLAC - ANGELES - PAMPANGA

BACKGROUND RESEARCH, ISOSTATIC MAP & METRO MATRIX

APRIL 2015 - JULY 2015 | PROF. DR. DIANE L. BARRERA, DR. JONAS M. LEONARDO, MARIBEL ROSARIO & RANIERO L. AM

TAP OVERVIEW

GENERAL INFORMATION
GENERAL STATE OF REGION III (Central Luzon)

VERTICAL CENTER
TARLAC

COMMERCIAL CENTER
ANGELES

INSTITUTIONAL & EDUCATIONAL CENTER
PAMPANGA

WATER INFRASTRUCTURE

ROAD INFRASTRUCTURE

DIRECTIONALITIES

CHESSBOARD PLANNING

Zone	Area	Characteristics
Zone I	Central	High density, mixed use
Zone II	North	Low density, residential
Zone III	South	Medium density, commercial
Zone IV	East	Low density, agricultural
Zone V	West	Medium density, industrial

ISOSTATIC MAP

METRO MATRIX

LEGEND

- High Density
- Medium Density
- Low Density

LAND-USE SCENARIOS

- Scenario 1: High Density Core
- Scenario 2: Medium Density Expansion
- Scenario 3: Low Density Periphery

METRO BATANGAS PLAN

BACKGROUND RESEARCH, ISOSTATIC MAP & METRO MATRIX

METRO BATANGAS PLAN

METRO BATANGAS PLAN

CENTRAL LUZON: Nueva E

REGION III

Central Luzon

- 1. Central Luzon
- 2. Luzon

METRO M

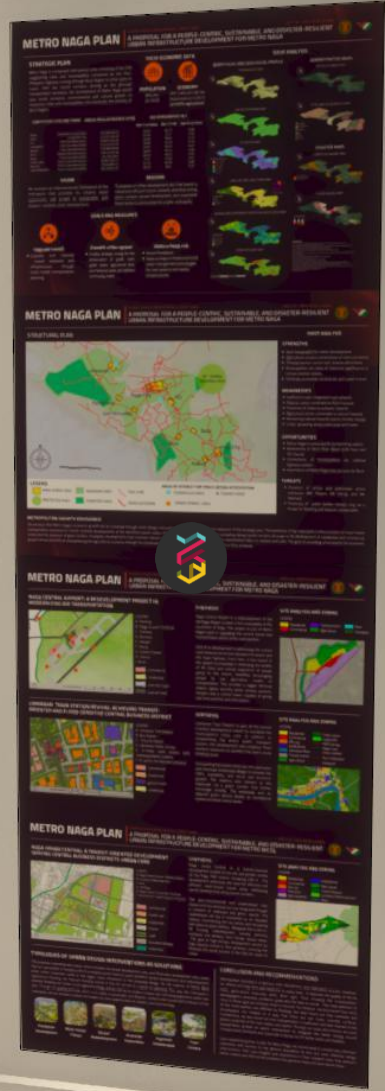
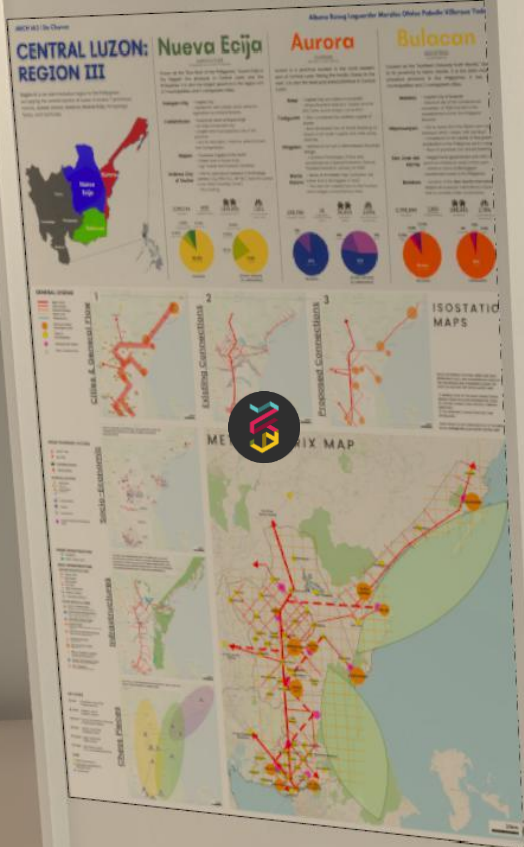

Metro Cebu

2015-2020 Vision
"A more sustainable and resilient Metro Cebu, socially, environmentally, and economically"

VISIONS

- 1. **Urban Form and Structure**
- 2. **Urban Design**
- 3. **Urban Development**



This panel for Metro Cebu features a top section with a vision statement and three main planning categories: Urban Form and Structure, Urban Design, and Urban Development. It includes various maps, diagrams, and photographs illustrating urban planning concepts and infrastructure projects.

KAROS



This panel for the KAROS project includes architectural renderings of a modern building, site plans, and descriptive text about the project's design and location.

METRO GAVITE

150 LAYERED TOWER

VISIONS

- 1. **Urban Form and Structure**
- 2. **Urban Design**
- 3. **Urban Development**



This panel for Metro Gavite features a top section with a vision statement and three main planning categories: Urban Form and Structure, Urban Design, and Urban Development. It includes various maps, diagrams, and photographs illustrating urban planning concepts and infrastructure projects.

METRO SAN LAZAR

SAN PABLO HERITAGE ZONE

LUCENA RIVERFRONT



This panel displays planning information for Metro San Laz and the Lucena Riverfront, featuring maps, diagrams, and descriptive text for these specific urban areas.

METRO SAN LUIS

STRUCTURAL PLAN

SAN PABLO HERITAGE ZONE

LIMA, LIMA BUSINESS DISTRICT

LUCBAN GREENFIELD DEVELOPMENT

LUCENA RIVERFRONT NEW TOWN

REGION III: CENTRAL LUZON
METRO MATRIX MAP

REGION III: CENTRAL LUZON
METRO MATRIX MAP

METRO-LUCENA

STRUCTURAL PLAN

URBAN DESIGN INTERVENTIONS







BS ARCHITECTURE 4TH YEAR

Arch 142:
Metropolitan Architecture



TURE



DALUVAN

DALUVAN

AGWA-KULTURA
THE NEW BAHANDI AGRICULTURE LIVELIHOOD AND COMMUNITY LEARNING CENTER

AGWA-KULTURA
The New Bahandi Agriculture Livelihood and Community Learning Center

Huni

Huni
MUSIC PARK

BAHANDI

BAHANDI
A Proposed Agri-Tourism Center in Gingoog City

kalinga

BAHANDI





HUNI
MUSIC PARK

This exhibition board features a top section with a site plan and various diagrams. The middle section contains architectural drawings, including floor plans and elevations, along with descriptive text. The bottom section is dominated by a large, vibrant photograph of the proposed music park building and its surrounding landscape.

bahay + lalian

SAGAL CONCEPT DESIGN

SITE ANALYSIS

LANDSCAPE CONCEPT DESIGN

ARCHITECTURAL DESIGN

This board is a comprehensive architectural presentation. It includes a site analysis map, conceptual landscape designs, and detailed architectural drawings such as floor plans and elevations. A central logo, a stylized 'S' in a circle, is prominently displayed. The bottom of the board features a large photograph of the building's exterior.

kalinga hub

This board presents a multi-faceted architectural study. It includes a site plan, various diagrams, and architectural drawings. The bottom section features a photograph of the building's facade, which has a modern, multi-story design.

BAHAY PAROLA

MACRO ANALYSIS

MICRO ANALYSIS

ARCHITECTURAL DESIGN

This board provides a detailed architectural analysis and design. It features macro and micro analysis sections with maps and diagrams, followed by architectural drawings and a large photograph of the building's exterior. A central logo, a stylized 'S' in a circle, is also present.



PROPOSAL FOR THE DEVELOPMENT OF
CEBU CENTRAL STATION
PHASE 1 AND 2 (C1)





Background

Significance

Macroanalysis

Microanalysis

Programming



University of Makati
Center for Environmental Sciences



Background

Form Finding

Significance

Agenda

Macroanalysis

Microanalysis



Programming



University of Makati
Center for Environmental Sciences
Basilio A. Pangilinan



CLAR
G-HU



CLARK G-HUB

ARCH 142

BACKGROUND

CONCEPT

1

2

3





4

5

6

7

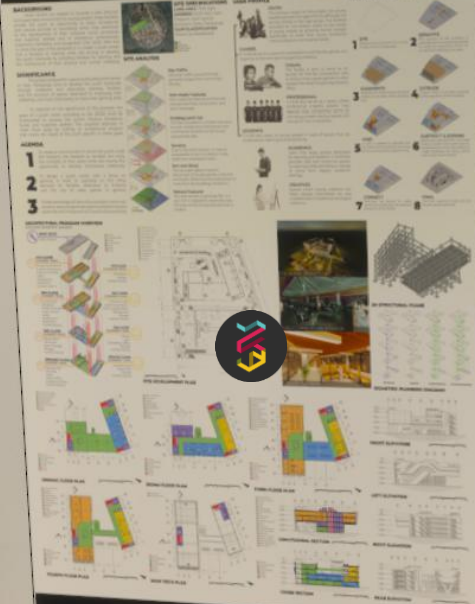
8



CoExist

BULACAN ECOTOURIST LODGING WITH BIRD SANCTUARY

AN ECOCOLOGICAL LODGING PROPOSAL FOR BULACAN PROVINCE, PHILIPPINES



DALUYAN

MIXED-USE FISHERIES & AQUACULTURE CENTER
OF ALABUJO, MINDANAO ORIENTAL

Architectural site development plan for Daluyan, featuring a site development plan, architectural site plan, ground floor plan, second floor plan, elevations, sections, and structural details. The plan includes a circular logo with stylized letters 'H' and 'M'.

FAHR HUB

Architectural rendering of the Fahr Hub building, showing the building's facade, surrounding landscape, and a circular logo with stylized letters 'H' and 'M'.

HUNI MUSIC PARK

Architectural rendering of the Huni Music Park building, showing the building's facade, surrounding landscape, and a circular logo with stylized letters 'H' and 'M'.

InGen
AN INTERGENERATIONAL HOUSING FOR
YOUNG ADULTS AND SENIOR CITIZENS



IDENTITY AWARENESS
Having an identity awareness, you will be able to identify the things that are important to you and your family. It will help you to understand your own and your family's values, beliefs, and traditions. This will help you to make decisions that are in line with your own and your family's values, beliefs, and traditions.

STRENGTH OF TRADITION
The strength of tradition is the ability to pass on the values, beliefs, and traditions of your family and community to the next generation. This is important because it helps to create a sense of continuity and belonging. It also helps to ensure that the values, beliefs, and traditions of your family and community are preserved for future generations.

SOCIAL COHESION
Social cohesion is the ability of a community to work together to solve problems and improve the quality of life for all its members. This is important because it helps to create a sense of community and belonging. It also helps to ensure that everyone in the community has access to the resources and services they need to thrive.



InGen
Connecting across Generations

kalinga hub



Design Agency
[Detailed description of the design agency's role and services]

Design Agency
[Detailed description of the design agency's role and services]

Design Agency
[Detailed description of the design agency's role and services]

Design Agency
[Detailed description of the design agency's role and services]



kalinga hub

MANILA EASTERN AGRI-LAB

AGRI-LAB

The poster for the Manila Eastern Agri-Lab project features a detailed site plan at the top right, showing various zones and green spaces. Below the plan are several sections of text and smaller diagrams, including a triangular diagram with a yellow triangle. The bottom section of the poster is dominated by a large, vibrant photograph of the completed Agri-Lab building, a modern structure with a wide facade and a sign that reads 'AGRI-LAB'.

Marikina Art Incubator

Marikina Art Incubator

The Marikina Art Incubator poster displays a variety of architectural drawings, including floor plans, elevations, and sections. A central circular logo with a colorful, stylized 'M' is prominent. The bottom of the poster features a large, clear photograph of the building's exterior, showcasing its modern design and large windows.

NORTH LINK

NORTH LINK
A CULTURAL HUB IN MALABON CONNECTING
HERITAGE SITES AND INDUSTRY OF LILIAN

The North Link poster includes a site plan at the top right and a large, detailed architectural rendering of the building's exterior at the bottom. The rendering shows a modern, multi-story structure with a distinctive, curved roofline. The poster also contains various smaller diagrams and text blocks, along with a circular logo similar to the one on the Marikina Art Incubator poster.









BS ARCHITECTURE
4TH YEAR

Arch 143:
Lighting

The poster features a dark red background with a diagonal split to a lighter red. It includes a logo with a stylized 'S' and 'A' in the top left, a smaller version of the same logo in the center, and several small circular icons with light rays at the bottom. The text is in white, bold, sans-serif fonts.



A white exhibition panel with a small section of text and diagrams near the top.



A white exhibition panel with a small section of text and diagrams near the top.



An exhibition panel featuring three columns of architectural drawings, including floor plans and elevations.



An exhibition panel titled 'ARCHITECTURAL LIGHTING SCHEMATICS' featuring various diagrams and architectural renderings.



An exhibition panel with a grid of architectural drawings and diagrams.





LANDSCAPE
ARCHITECTURE
100 YEAR

G-HUB:

G-HUB:

G-HUB:

ARCHITECTURAL LIGHTING SCHEMATICS

01

02

03

PERFORMING ARTS CENTER

01

02



This exhibition board is divided into three main sections: 'kalinga hub' (left), 'kalinga fit' (center), and 'kalinga hub' (right). The left section features a large architectural rendering of a modern building complex and a circular diagram with arrows. The center section is titled 'Kalinga Fit' and includes a grid of smaller images and text, with a central circular logo. The right section contains more architectural drawings and diagrams. A pink arrow points to the left edge of the board.

This exhibition board is titled 'PLAYHOUSE' at the top. It features a large central architectural rendering of a modern building with a green lawn in front. Above and around the rendering are various smaller images, diagrams, and text blocks. A pink arrow points to the right edge of the board.

This exhibition board is titled 'Mandour City Mixed Income & Use Development'. It is divided into several sections: 'Daylight Strategies' (top left, red background), 'Conceptual Lighting Design' (top right, red background), 'Sun Paths' (middle left, circular diagram), 'Conceptual Lighting Design' (bottom left, red background), and 'Analysis & Summary' (bottom center). It includes various diagrams, tables, and architectural renderings. A pink arrow points to the right edge of the board.

This exhibition board is titled 'SITE SERVICE LAYOUT PLAN'. It features a large central site plan diagram with various colored zones and buildings. Surrounding the plan are smaller images, diagrams, and text blocks. A pink arrow points to the right edge of the board.



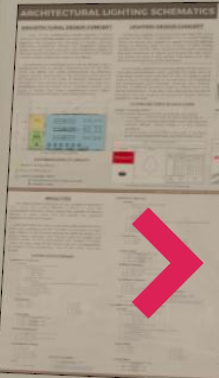

CRUSADE

Architectural lighting schematic showing building footprints and surrounding green spaces.

ARCHITECTURAL LIGHTING SCHEMATICS

Architectural lighting schematic showing building footprints and surrounding green spaces. Includes sections for site orientation, lighting design concepts, and site development.

THE ECO DEPOT

THE ECO DEPOT

Site orientation

Lighting design concepts

Site development

Exterior lighting design

Interior lighting design

Overall effect

The Eco Depot project layout, including site orientation, lighting design concepts, and site development. Includes a circular inset showing a building detail.





CONCEPTS

Architectural development, Lighting design strategy, Lighting strategy

INDOOR LIGHTING SCHEMATIC

Site development plan, Indoor lighting schematic

LIGHTING LAYOUT

Lighting layout, Lighting specifications

RECOMMENDATION & ACTION

Recommendation & Action



MONTI COMMERCIAL OFFICE BLOCK

Architectural design concept

RESTAURANT INTERIOR SPACE

Interior design

GREEN ATRIUM EXTERIOR SPACE

Exterior design

ILLUMINATION LEVEL REQUIREMENT & STOCK BOARD

Lighting requirements

PROCESSED

Process flow







B LANDSCAPE ARCHITECTURE 3RD YEAR

L Arch 132: Protected Area Landscape Design

The panel features a green background with a stylized landscape illustration at the bottom showing trees, paths, and small human figures. Two logos are positioned at the top: a circular logo with colorful abstract shapes on the left, and a square logo with a stylized 'B' and 'A' on the right.

CRUSADE

This panel is divided into three sections, each featuring a map and a legend. The top section shows a green map of a region with a legend listing 'Protected Area', 'Landscape Area', 'Public Open Space', 'Water Body', and 'Other'. The middle section shows a map with green trees and a legend listing 'Landscape Area', 'Public Open Space', and 'Water Body'. The bottom section shows a map with buildings and trees, with a legend listing 'Protected Area', 'Landscape Area', 'Public Open Space', 'Water Body', and 'Other'. Each section includes a scale bar and the 'CRUSADE' logo.

BEYOND THE BLUES

This panel is divided into two main sections. The top section is titled 'BEYOND THE BLUES' and features a blue background with various diagrams, maps, and illustrations related to landscape design. The bottom section is also titled 'BEYOND THE BLUES' and features a similar layout with diagrams and illustrations. The 'CRUSADE' logo is visible at the bottom of the panel.

TANA

This panel features a large map of a lake area (Tana) with surrounding landscape elements. It includes various diagrams, illustrations, and text blocks. The 'CRUSADE' logo is visible at the bottom.

M' LOGO'

This panel features a central logo with the letter 'M' and various surrounding diagrams and illustrations. The 'CRUSADE' logo is visible at the bottom.

This panel contains several smaller diagrams, maps, and illustrations related to landscape architecture. The 'CRUSADE' logo is visible at the bottom.

PROJECT & SHOP FACILITIES

ALUMNI HUB PLANS

TANA

Architectural drawings and site plan for TANA, including a large green area and a building complex.

BEYOND THE BLUES

ENVIRONMENTAL CONCEPT

LANDSCAPE CONCEPT

Architectural drawings and site plan for 'BEYOND THE BLUES', featuring a blue-themed landscape with various plantings and structures.

PROJECT CRUSADE

LEGEND

- WALKWAY
- BIODIVERSITY
- WATER
- PLANTING
- LANDSCAPE

MASTER SITE DEVELOPMENT PLAN

Architectural drawings and site plan for Project Crusade, showing a large green area with various zones and facilities.

LEGEND

- WALKWAY
- BIODIVERSITY
- WATER
- PLANTING
- LANDSCAPE

SITE DEVELOPMENT PLAN

Architectural drawings and site plan for Project Crusade, showing a large green area with various zones and facilities.

LEGEND

- WALKWAY
- BIODIVERSITY
- WATER
- PLANTING
- LANDSCAPE

SITE DEVELOPMENT PLAN

Architectural drawings and site plan for Project Crusade, showing a large green area with various zones and facilities.

LEGEND

- WALKWAY
- BIODIVERSITY
- WATER
- PLANTING
- LANDSCAPE

LAKBAY-ARAI

Outdoor Lighting System for Markkay Spring Provincial Landscape

LAKBAY-ARAI

Outdoor Lighting System for Markkay Spring Provincial Landscape

THE SITE
DESIGN PHILOSOPHY
DESIGN CONCEPT
CHOSEN SITE

SITE ANALYSIS

DESIGN CONCEPT

LONGITUDINAL SECTION ELEVATION

CROSS SECTION ELEVATION

ABOUT ANALYSIS

LAKBAY-ARAI
Outdoor Lighting System for Markkay Spring Provincial Landscape

AERIAL PERSPECTIVE

ABEL LOCO

LANDSCAPE ARCHITECTURE

ABEL LOCO

LANDSCAPE ARCHITECTURE

PESTLE & SWOT ANALYSIS

PESTLE	SWOT
P OLITICAL Government support for sustainable development. Local government's commitment to environmental protection.	S TRENGTHS Abundant natural resources and scenic views. Proximity to urban areas and infrastructure.
E CONOMIC Growing tourism industry and local economy. Potential for eco-tourism and outdoor recreation.	W EAKNESSES Limited budget for large-scale development. Oversight of land use and zoning regulations.
S OCIAL Community involvement and local participation. Cultural heritage and traditional values.	O PPORTUNITIES Integration of traditional and modern design elements. Collaboration with local artists and craftsmen.
T ECHNOLOGICAL Use of sustainable materials and construction techniques. Implementation of smart lighting and irrigation systems.	T HREATS Overdevelopment and loss of natural character. Climate change and environmental degradation.

DESIGN CONCEPT

THEORY

SPACE PROGRAMMING

ABEL LOCO

LANDSCAPE ARCHITECTURE

SITE ELEVATION

PROPERTY PLAN

SITE DEVELOPMENT PLAN

INCANTO

INCANTO

8 LANDSCAPE ARCHITECTURE 3RD YEAR



Talingap

Strengths
- Strategic Location
- Natural Beauty
- Cultural Heritage
- Proximity to Urban Area

Weaknesses
- Limited Access
- Lack of Infrastructure
- Environmental Degradation

Opportunities
- Ecotourism
- Cultural Tourism
- Sustainable Development

Threats
- Urban Sprawl
- Deforestation
- Pollution

Strategic Concept
- Sustainable Land Use
- Cultural Preservation
- Environmental Protection

Strategic Philosophy
- Community Participation
- Environmental Stewardship
- Cultural Revival

Strategic Pathway
- Infrastructure Development
- Cultural Programming
- Environmental Management

PATAK NG TAKTAK

A cultural park along Antena's Himpang Taklak watershed

Concept
Taktak (or kampos, sahi)

Philosophy
Symbolic Capital Theory

INVENTORY
- Cultural Assets
- Natural Resources
- Infrastructure

ANALYSIS
- SWOT Analysis
- Stakeholder Analysis
- Cultural Mapping

PERSPECTIVES

IKINTAL ANG TAAL

Concept
- Sustainable Land Use
- Cultural Preservation
- Environmental Protection

Philosophy
- Symbolic Capital Theory
- Community Participation

INVENTORY
- Cultural Assets
- Natural Resources
- Infrastructure

ANALYSIS
- SWOT Analysis
- Stakeholder Analysis
- Cultural Mapping

PLURIBUSO A PROPOSED RECREATION PLAN OF MOUNT ADJANG PARKS AND WILDLIFE CENTER

Background
The Mount Adjang Park and Wildlife Center (MAWLC) is one of the 10 largest parks in the region. It is a natural habitat for many species of birds and animals. The MAWLC is a natural habitat for many species of birds and animals. The MAWLC is a natural habitat for many species of birds and animals.

Objectives
The MAWLC is a natural habitat for many species of birds and animals. The MAWLC is a natural habitat for many species of birds and animals. The MAWLC is a natural habitat for many species of birds and animals.

Site Analysis
The MAWLC is a natural habitat for many species of birds and animals. The MAWLC is a natural habitat for many species of birds and animals. The MAWLC is a natural habitat for many species of birds and animals.

Site Plan
The MAWLC is a natural habitat for many species of birds and animals. The MAWLC is a natural habitat for many species of birds and animals. The MAWLC is a natural habitat for many species of birds and animals.

Section Elevation
The MAWLC is a natural habitat for many species of birds and animals. The MAWLC is a natural habitat for many species of birds and animals. The MAWLC is a natural habitat for many species of birds and animals.

MT. TIMOLAN PROTECTED LANDSCAPE ECOTOURISM PARK

Functional Diagram
The MAWLC is a natural habitat for many species of birds and animals. The MAWLC is a natural habitat for many species of birds and animals. The MAWLC is a natural habitat for many species of birds and animals.

Site Development Plan
The MAWLC is a natural habitat for many species of birds and animals. The MAWLC is a natural habitat for many species of birds and animals. The MAWLC is a natural habitat for many species of birds and animals.

Section Elevation
The MAWLC is a natural habitat for many species of birds and animals. The MAWLC is a natural habitat for many species of birds and animals. The MAWLC is a natural habitat for many species of birds and animals.

Mow Up Plans
The MAWLC is a natural habitat for many species of birds and animals. The MAWLC is a natural habitat for many species of birds and animals. The MAWLC is a natural habitat for many species of birds and animals.

Canopy Walk
The MAWLC is a natural habitat for many species of birds and animals. The MAWLC is a natural habitat for many species of birds and animals. The MAWLC is a natural habitat for many species of birds and animals.

Bird Watching Area
The MAWLC is a natural habitat for many species of birds and animals. The MAWLC is a natural habitat for many species of birds and animals. The MAWLC is a natural habitat for many species of birds and animals.

PANAGTALON

CONCEPTS

DEVELOPMENT PLAN

BLOW-UP

DESIGN PHILOSOPHY

DESIGN THEORIES

PLAN ADJUSTMENT THEORY

DENCANTO

COLLEGE OF ARTS AND DESIGN UNIVERSITY OF THE PHILIPPINES - CAGAYAN
A BRANCH IN PANGASINAN, PHILIPPINES
SITE DESIGN
SITE MAP AND BOUNDARY

DESIGN CONCEPTS

DESIGN PHILOSOPHY

DESIGN THEORIES

PLAN ADJUSTMENT THEORY

RESEARCH

SWOT

DESIGN CONCEPT

DESIGN PHILOSOPHY

DESIGN THEORIES

PLAN ADJUSTMENT THEORY

MANSAKA

COLLEGE OF ARTS AND DESIGN UNIVERSITY OF THE PHILIPPINES - CAGAYAN
A BRANCH IN PANGASINAN, PHILIPPINES
SITE DESIGN
SITE MAP AND BOUNDARY

DESIGN CONCEPTS

DESIGN PHILOSOPHY

DESIGN THEORIES

PLAN ADJUSTMENT THEORY

RESEARCH

SWOT

DESIGN CONCEPT

DESIGN PHILOSOPHY

DESIGN THEORIES

PLAN ADJUSTMENT THEORY







B LANDSCAPE ARCHITECTURE 3RD YEAR

L Arch 132:
Botanical Park
Landscape Design

AGAS AY NABE-AS

Manog Bantay

PUNYANIMAN BAYAN



MINOTANGAN IBATAN

Without Ecological Barrier and Suburban

DESIGN CONCEPT

DESIGN PRINCIPLES

DESIGN PROGRAM

Manog Bantay

NORTHWEST PANAY PENINSULA NATURAL PARK

DESIGN CONCEPT

DESIGN PRINCIPLES

DESIGN PROGRAM

DESIGN PRINCIPLES

DESIGN PROGRAM

AGAS AY NABE-AS

DESIGN CONCEPT

DESIGN PRINCIPLES

DESIGN PROGRAM

DESIGN PRINCIPLES

DESIGN PROGRAM

SECTION-ELEVATION Y-Y

SECTION-ELEVATION X-X

THE BARKY OF Untold Stories

MARKLEIGH SPRING PROTECTED LANDSCAPE

DESIGN PHILOSOPHY

DESIGN CONCEPT

FUNCTIONAL DIAGRAM

SECTION ELEVATION

WATER FEATURES SPOT PERSPECTIVE

MEAN GARDEN SPOT PERSPECTIVE

FLOWER GARDEN SPOT PERSPECTIVE

AERIAL PERSPECTIVE

SPACE PROGRAMMING ABEL ILOCO

A BOTANICAL GARDEN FEATURING PHYSICAL POINTS OF INTEREST RECREATION

DESIGN CONCEPT

BUBBLE DIAGRAM

FUNCTIONAL DIAGRAM

PHILOSOPHY

THEORY

WELCOME

ELEVATION

SECTION

SITE DEVELOPMENT PLAN

FOCAL POINT (D) AREA

AERIAL PERSPECTIVE

BACAOAN BOTANICAL

A PROPOSED BOTANICAL GARDEN DESIGN IN BACAOAN, CAGAYAN

DESIGN CONCEPT

BACAOAN THE MANGROVE

SECTION ELEVATION

DESIGN PHILOSOPHY

CONCEPTUAL FRAMEWORK

PROTECT

PROMOTE

PROVIDE

Forest

Beach Forest

Research Hub

Mangrove Forest & Marshlands

Grasslands

SITE DEVELOPMENT PLAN

Y-BAKAJAN

Bajina

Hinulugang Taktak Botanical Garden

Landscape Design by [Logo]

A botanical park that educates visitors and users about agriculture on sustainability, conservation, and environmental-friendly technologies, services, tools, and values.

Hinulugang Taktak Protected Landscape

It is one of the largest forest reserves in the Philippines. It is a natural area that is protected by the government. It is a natural area that is protected by the government. It is a natural area that is protected by the government.

DESIGN CONCEPT
 Focus: **NEURO-COGNITIVE PERSPECTIVE**
 Method: **TAKTAK**
 Approach: **COVULGAR**

DESIGN PHILOSOPHY
 Building a sustainable and resilient landscape that is both functional and aesthetically pleasing.

SPACE PROGRAMMING

Hinulugang Taktak Botanical Garden

SITE DEVELOPMENT PLAN

SECTION-ELEVATION A-A'

SECTION-ELEVATION B-B'

PERSPECTIVES

Kin-Taal Garden

A Proposed Botanical/Recreational Garden for Taal Volcano Protected Landscape

DESIGN PHILOSOPHY
 Building a sustainable and resilient landscape that is both functional and aesthetically pleasing.

SECTION-ELEVATION A-A'

SECTION-ELEVATION B-B'

PERSPECTIVES

NITO BOTANICAL PARK

A PROPOSED BOTANICAL PARK DESIGN FOR NIJWS

SITE DESCRIPTION

DESIGN CONCEPT: Weaving the landscape together

DESIGN PHILOSOPHY: Inspired by Nature

SITE INVENTORY AND ANALYSIS

Strengths **Weaknesses** **Opportunities** **Threats**

PHASE 1

AERIAL PERSPECTIVE

SITE DEVELOPMENT PLAN

SECTION-ELEVATIONS

SPOT PERSPECTIVES

THE MABINI PROTECTED LANDSCAPE & SEASCAPE (MPLS)

BANTAY-BAKAUAN:

OVERVIEW

RESEARCH OBJECTIVE

THREE PART TOURISM PLAN

- 1 PHASE 1
- 2 PHASE 2
- 3 PHASE 3

MAIN STRUCTURE

MAIN INFRASTRUCTURE

MAIN COMMUNITY

MAIN THREAT

LANDSCAPE & SEASCAPE

AfterLife

SITE DEVELOPMENT PLAN



CASCADE

A PROPOSED BOTANICAL PARK AND WILDLIFE CENTER

PROBLEM

- 01. Lack of green spaces in the area
- 02. Limited recreational facilities
- 03. Poor air quality and noise pollution

DESIGN CONCEPT

DESIGN PHILOSOPHY

DESIGN THEORIES

SWOT

Strengths	Weaknesses
• Proximity to existing infrastructure	• Limited budget
• High potential for biodiversity	• Lack of local expertise
• Support from local government	• Limited public participation

VISION

A beautiful park that promotes ecological sustainability, provides a habitat for native species, and offers a recreational space for the community.

Architectural firm logo: A stylized 'S' and 'W' intertwined in a circle.

A BETTER WAY FOR THE PROPOSED BOTANICAL PARK AND ARBORETUM AROUND NINOT AQUINO PARKS AND WILDLIFE CENTER'S LAGOON

DESIGN CONCEPT

Being a park, the Wildlife Center is located in an urban area, surrounded by dense urban and commercial areas. The park is a great addition to the city. The location is strategic and accessible. The proposed design will be based on the local conditions and the site's potential. The design will be a combination of nature and urban.

DESIGN CONCEPT TRANSFORMATION

SITE PLAN

Architectural firm logo: A stylized 'S' and 'W' intertwined in a circle.

BACAOAN BOTANICAL

DESIGN CONCEPT

DESIGN PHILOSOPHY

VISION

Architectural firm logo: A stylized 'S' and 'W' intertwined in a circle.

HILAMDAGAN

A Proposed Botanical Park & Arboretum in Mt. Tandang Sora Landscape

DESIGN CONCEPT

DESIGN PHILOSOPHY

VISION

SITE DEVELOPMENT PLAN

SECTION ELEVATION A-A'

SECTION ELEVATION B-B'

ENTRANCE SPOT PERSPECTIVE

WALKWAY TRILLIS SPOT PERSPECTIVE

AERIAL PERSPECTIVE

Architectural firm logo: A stylized 'S' and 'W' intertwined in a circle.

ISURO

PROJECT BACKGROUND

VISION

SITE ANALYSIS

THEORETICAL FRAMEWORK

DESIGN PHILOSOPHY

DESIGN OBJECTIVES

DESIGN CONCEPT

FUNCTIONAL DIAGRAM

SITE DEVELOPMENT PLAN

AERIAL PERSPECTIVE

NATURE WALK

COMMERCIAL AREA

WELL-TIME TOGETHER

SENTRY GARDEN

WATER GARDEN

CHILDREN'S GARDEN

MINA EN KUWEBA

MINALUNGAO BOTANICAL GARDEN

DESIGN CONCEPT

DESIGN PHILOSOPHY

NUMBER KEY

MINA EN KUWEBA

MINALUNGAO BOTANICAL GARDEN

ABE LOCO

DESIGN CONCEPT

DESIGN PHILOSOPHY

NUMBER KEY







IMPROVING & REVITALIZING URBAN SPACES
 THE RECREATIONAL AND COMMUNITY COMPONENTS OF A LARGER URBAN DEVELOPMENT PROJECT

RESEARCH DESIGN

SITE DEVELOPMENT PLAN

SITE ANALYSIS

GENERAL SECTION ELEVATIONS

DECK SECTION ELEVATIONS

BLIND UP PLANS

SANKAKANA-UY FARM
 RAJULI, MANGALAYAT, BANGKOK

PHYSICAL SITE

SANKAKANA-UY FARM
 RAJULI, MANGALAYAT, BANGKOK

PHYSICAL SITE

PHYSICAL SITE

After/Life
 Evaluation of the La Forest Memorial Park in Mahulabong, Pangasinan as a Regenerative Forestry Landscape through an Environmental Psychology Design Approach

RESEARCH DESIGN

THEORETICAL FRAMEWORK

CONCEPTUAL FRAMEWORK

FIELD ANALYSIS

DESIGN VISUALIZATIONS

DESIGN VISUALIZATIONS

LANDSCAPE ARCHITECTURE YEAR

Tatag ng Tatalon

This panel features a top section with a 3D site model and various diagrams. The middle section displays a detailed site development plan with a central logo. The bottom section contains architectural elevations and smaller site diagrams.

THE LICABEROP ADULTOUSHIP FARM

This panel shows an aerial architectural rendering of a farm complex with various buildings and green spaces. It includes smaller diagrams and text blocks.

RECREATIONAL GARDENS

This panel features a site plan for recreational gardens, showing a central area with a logo and surrounding green spaces. It includes descriptive text and small images.

This panel shows an aerial perspective rendering of a farm area with numbered callouts (1-6) pointing to specific features. It includes small inset images and text.

CO2C0: A CLIMATE-SMART AGROFOREST PARK USING NATURE BASED DESIGN IN SIARGAO'S CLIMATE FIELD SCHOOL

LOCATION MAP

SITE INVENTORY AND ANALYSIS

FIELD ANALYSIS: SOIL, CLIMATE, TOPOGRAPHY, VEGETATION, WATER, CULTURE, HISTORY

DESIGN CONCEPT: CO2C0

FUNCTIONAL DIAGRAMS

CONCEPTUAL PRESENTATION

This panel is a detailed site analysis and conceptual design. It includes a location map, site inventory diagrams, a design concept diagram, functional diagrams, and a conceptual presentation.

CO2C0: A CLIMATE-SMART AGROFOREST PARK USING NATURE BASED DESIGN IN SIARGAO'S CLIMATE FIELD SCHOOL

This panel shows a site development plan with a central logo and architectural elevations for the Main Entry Plaza, Terrace (Zoo) Garden, and Farmer's Village. It includes a scale bar and a blow-up section elevation.

CO2C0: A CLIMATE-SMART AGROFOREST PARK USING NATURE BASED DESIGN IN SIARGAO'S CLIMATE FIELD SCHOOL

This panel features an aerial perspective rendering of the CO2C0 park, showing the circular central plaza, surrounding green spaces, and buildings. It includes labels for the Main Entry Plaza, Terrace (Zoo) Garden, and Farmer's Village.



BRINGING NEW LIFE

Urban Greening and Space Plan

A Landscape Narrative Approach in Preserving the Cultural Heritage of Angono-Binangonan Petroglyphs

This section includes a site plan, a 'BRINGING NEW LIFE' diagram, and various smaller diagrams and text blocks.

BRINGING NEW LIFE

Urban Greening and Space Plan

This section features a central logo with the letters 'G' and 'L' in a stylized, colorful font. It is surrounded by various landscape design diagrams, including cross-sections and site plans.

BRINGING NEW LIFE

Urban Greening and Space Plan

This section continues the landscape design diagrams and includes a central logo with the letters 'G' and 'L' in a stylized, colorful font.

Urban Greening and Space Plan

A Landscape Narrative Approach in Preserving the Cultural Heritage of Angono-Binangonan Petroglyphs

Site Location

Site Development Plan

This large exhibit board contains a title, a 'Site Location' map, a 'Site Development Plan' map, and various diagrams and text blocks. A central logo with the letters 'G' and 'L' is prominently displayed.

Urban Greening and Space Plan

A small exhibit board featuring diagrams and text related to the urban greening and space plan.

Urban Greening and Space Plan

A small exhibit board featuring diagrams and text related to the urban greening and space plan.

INDAYOG PARK

DESIGN STRATEGY LAYERS

SITE OVERVIEW

SPACE PROGRAMME

THEORETICAL FRAMEWORK

SITE ANALYSIS

SECTION ELEVATION

LEGEND

ARABAL PERSPECTIVE

This large exhibit board features a 'SITE OVERVIEW' map, a 'SPACE PROGRAMME' diagram, a 'THEORETICAL FRAMEWORK' diagram, a 'SITE ANALYSIS' diagram, a 'SECTION ELEVATION' diagram, a 'LEGEND' table, and an 'ARABAL PERSPECTIVE' image. A central logo with the letters 'G' and 'L' is prominently displayed.

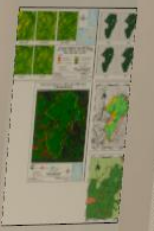



BATASAN HILLS HAVE EYES

SITE MAP

DESIGN STRATEGIES

Strategy	Description
1. Green Infrastructure	Integrate green spaces and trees into the urban fabric to improve air quality and provide shade.
2. Water Management	Implement rainwater harvesting and permeable paving to reduce runoff and manage stormwater.
3. Energy Efficiency	Use energy-efficient building materials and designs to reduce carbon footprint.
4. Sustainable Transportation	Promote walking, cycling, and public transit to reduce reliance on private vehicles.
5. Community Engagement	Involve local residents in the planning and implementation of green infrastructure projects.

GOING BEYOND NEUTRAL: CURBING CARBON SOURCE THROUGH URBAN FOREST PARK WITH CARBON SEQUESTRATION CENTERED DESIGN IN CAGAYAN DE ORO CITY

ABSTRACT

The project aims to create a sustainable urban environment by integrating green infrastructure and carbon sequestration into the design of an urban forest park. The park will serve as a carbon sink, offsetting the carbon emissions from the surrounding urban area. The design focuses on creating a multi-layered canopy and clustering of plants to maximize carbon sequestration. The park will also provide a space for recreation and community engagement.

DESIGN CONCEPT

FUNCTIONAL BACKBONE

DESIGN STRATEGIES FOR CARBON-SEQUESTERING FOREST PARK

- INCREASE VEGETATION**: Plant a variety of trees and shrubs to increase the overall green cover of the park.
- USE OF HIGH CARBON SEQUESTERING NATIVE PLANT SPECIES**: Select native plant species that are known for their high carbon sequestration capacity.
- CLUSTERING PLANTS (MULTI-LAYERING & CLUSTERING OF PLANTS)**: Group plants of different heights and species together to create a multi-layered canopy that maximizes carbon sequestration.
- CARBON DIRT & LOW CARBON CARBON MATERIALS**: Use carbon sequestration materials in the park's infrastructure, such as benches and lighting fixtures.



GOING BEYOND NEUTRAL: CURBING CARBON SOURCE THROUGH URBAN FOREST PARK WITH CARBON SEQUESTRATION CENTERED DESIGN IN CAGAYAN DE ORO CITY

PROJECT LOCATION

SITE HISTORY

KEY ANALYSIS

DESIGN CONCEPT

FUNCTIONAL BACKBONE

DESIGN STRATEGIES FOR CARBON-SEQUESTERING FOREST PARK

- INCREASE VEGETATION**: Plant a variety of trees and shrubs to increase the overall green cover of the park.
- USE OF HIGH CARBON SEQUESTERING NATIVE PLANT SPECIES**: Select native plant species that are known for their high carbon sequestration capacity.
- CLUSTERING PLANTS (MULTI-LAYERING & CLUSTERING OF PLANTS)**: Group plants of different heights and species together to create a multi-layered canopy that maximizes carbon sequestration.
- CARBON DIRT & LOW CARBON CARBON MATERIALS**: Use carbon sequestration materials in the park's infrastructure, such as benches and lighting fixtures.

SITE DEVELOPMENT PLAN

SECTION ELEVATION A-A

SECTION ELEVATION B-B



Deforestation to Diversification

Reforest Forest Conservation in Puerto Rico via City, Focused on Integrating Forestry, Agriculture and Aquaculture through Diversified Sustainable Landscape Design

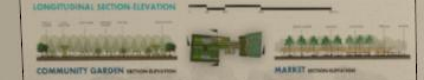

Deforestation to Diversification

Reforest Forest Conservation in Puerto Rico via City, Focused on Integrating Forestry, Agriculture and Aquaculture through Diversified Sustainable Landscape Design

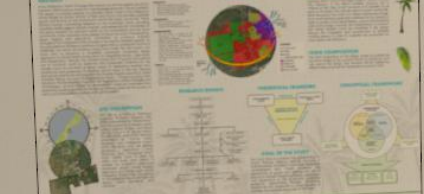

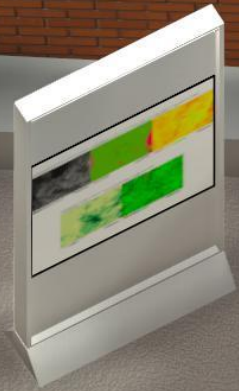
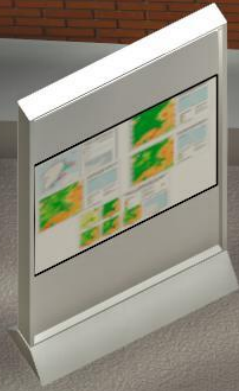

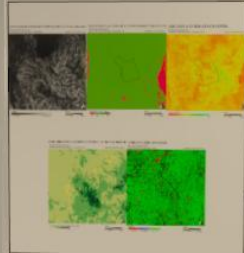
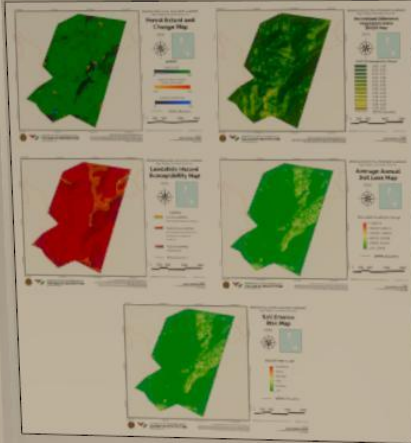
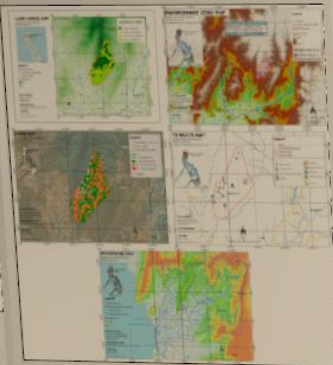
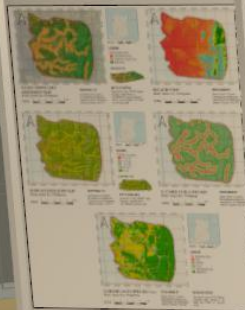

B LANDSCAPE ARCHITECTURE 3RD YEAR

L Arch 132: Protected Area Management through GIS Technologies

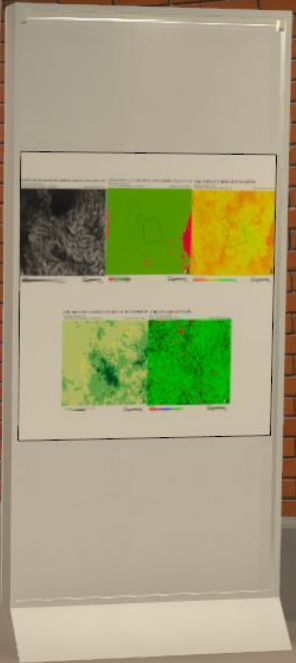
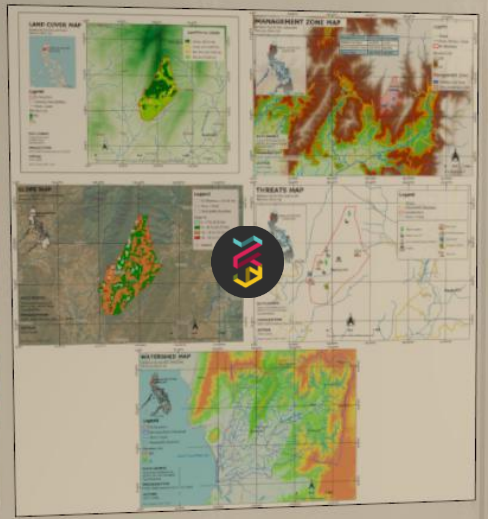
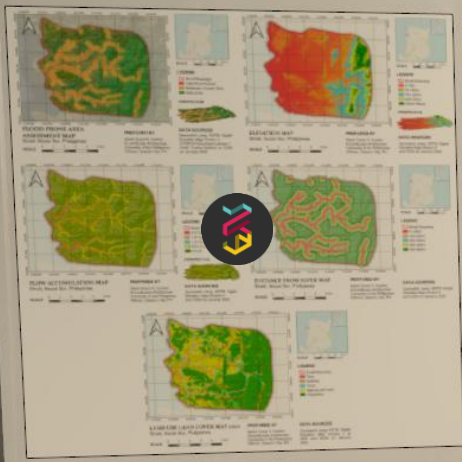

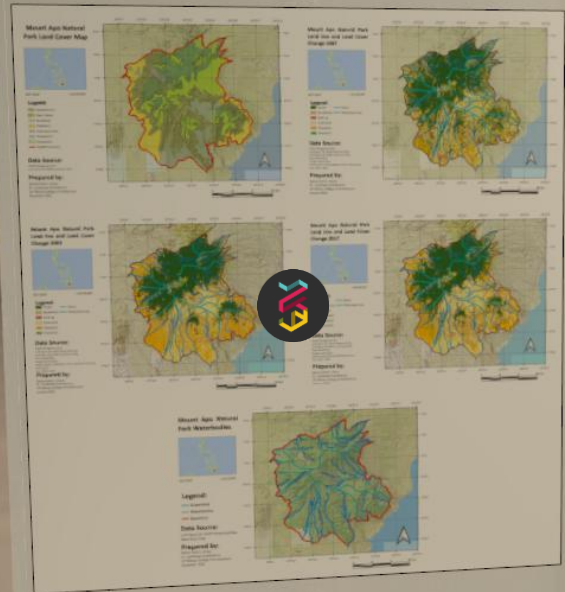
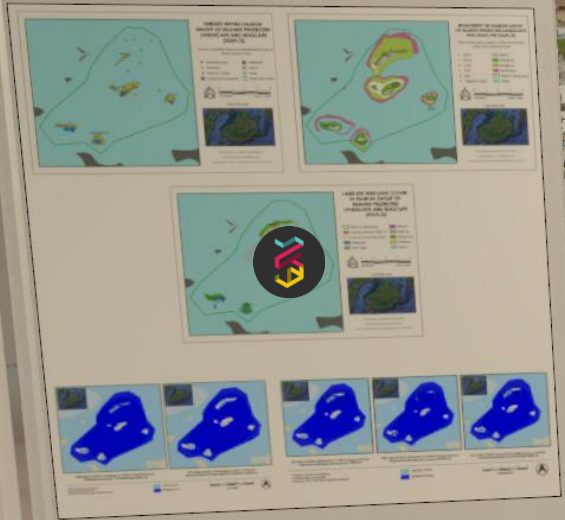

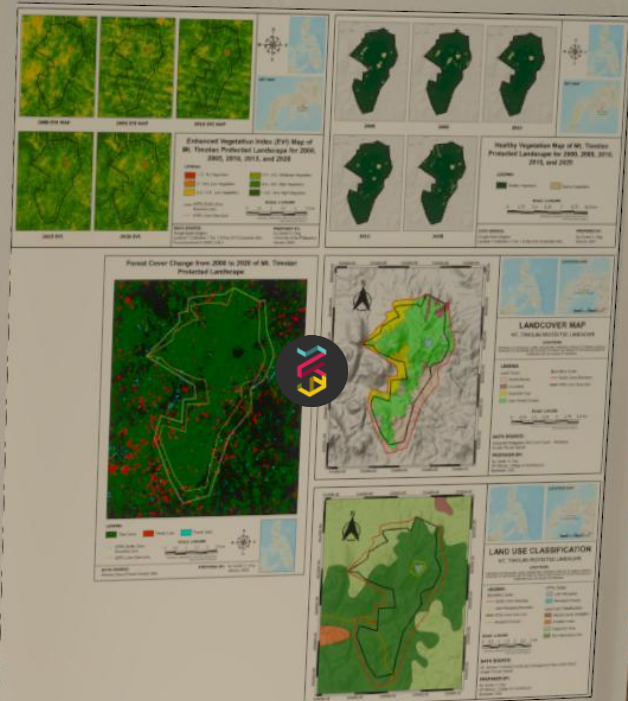
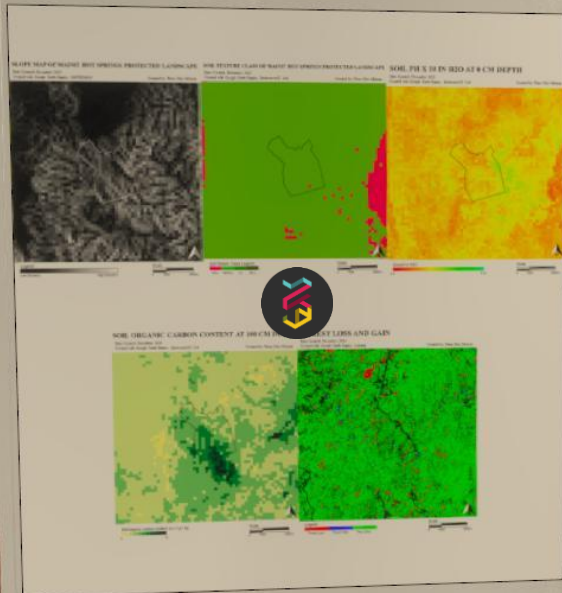





BS ARCHITECTURE
5TH YEAR

Arch 199.2:
Thesis

Decorative elements include a logo with stylized letters 'L' and 'A' in a circle, and several small circular icons with green and yellow patterns.



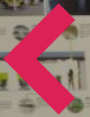



QUEZON CITY FOOD BANK A Battle Against Food Loss and Waste

Background of the study
The Philippines has one of the highest number of people who do not have food security. Despite having an agriculture industry, the nation is still struggling to solve the problem of the increasing food loss and waste (FLW) generated in the Philippines.

Research Objective
Since there are government programs for both food loss and waste, the objectives of this study are to look at proper transportation and storage facilities to reduce food loss and waste (FLW).

Context of the Food Bank Structure
The design is based on the existing structure of the building. The design is based on the existing structure of the building. The design is based on the existing structure of the building.

Design Objectives
The design objectives are to create a functional and efficient structure that can handle large quantities of food. The design objectives are to create a functional and efficient structure that can handle large quantities of food.

Site Development Plan
The site development plan shows the layout of the building and the surrounding area. The site development plan shows the layout of the building and the surrounding area.

Second Floor Plan
The second floor plan shows the layout of the second floor of the building. The second floor plan shows the layout of the second floor of the building.

West Side Elevation
The west side elevation shows the exterior view of the building from the west side. The west side elevation shows the exterior view of the building from the west side.

South Side Site Elevation
The south side site elevation shows the exterior view of the building from the south side. The south side site elevation shows the exterior view of the building from the south side.

Perspective View
The perspective view shows the building from a low angle, looking up. The perspective view shows the building from a low angle, looking up.



RESHAPING WORKSPACES

Introduction
The introduction discusses the importance of creating a modern and efficient workspace. The introduction discusses the importance of creating a modern and efficient workspace.

Site Criteria
The site criteria include factors such as location, size, and accessibility. The site criteria include factors such as location, size, and accessibility.

Design Development
The design development process involves creating a detailed plan for the workspace. The design development process involves creating a detailed plan for the workspace.

Site Plan
The site plan shows the layout of the workspace and the surrounding area. The site plan shows the layout of the workspace and the surrounding area.

Second Floor Plan
The second floor plan shows the layout of the second floor of the workspace. The second floor plan shows the layout of the second floor of the workspace.

West Side Elevation
The west side elevation shows the exterior view of the workspace from the west side. The west side elevation shows the exterior view of the workspace from the west side.

South Side Site Elevation
The south side site elevation shows the exterior view of the workspace from the south side. The south side site elevation shows the exterior view of the workspace from the south side.

Perspective View
The perspective view shows the workspace from a low angle, looking up. The perspective view shows the workspace from a low angle, looking up.



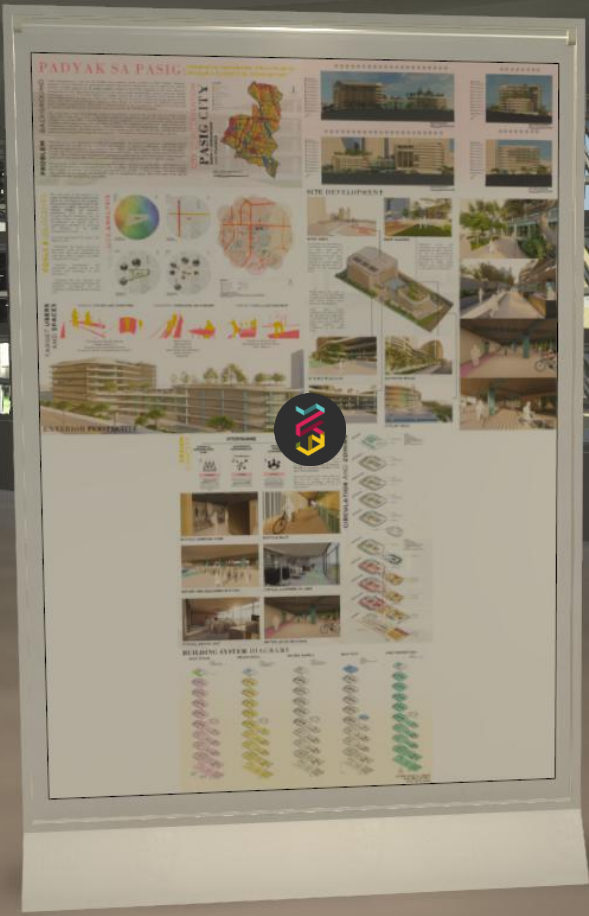

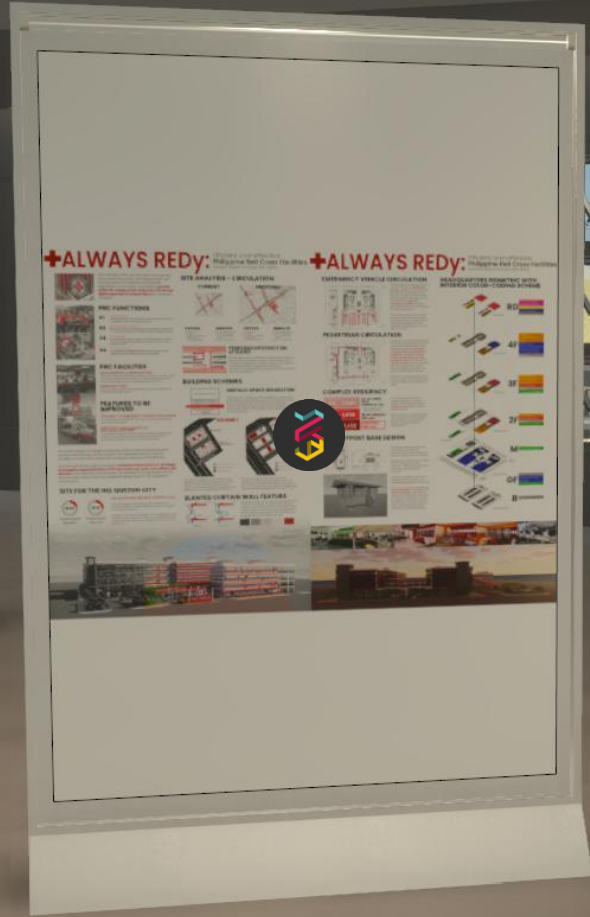



People Extinguish
Integrating Fire, Emergency and Safety into the Community Development

Logo: A circular emblem containing a stylized 'S' and 'E' in blue and yellow.

EARLY CHILDHOOD DEVELOPMENT AND COMMUNITY CENTRE

Logo: A circular emblem containing a stylized 'S' and 'E' in blue and yellow.



Logo: A circular emblem containing a stylized 'S' and 'E' in blue and yellow.



Pasig-Laguna Linkages

Design Narratives

This poster features two main sections: 'Pasig-Laguna Linkages' and 'Design Narratives'. The left side contains several maps and diagrams illustrating the geographical and infrastructural connections between Pasig and Laguna. The right side presents various design narratives, including architectural renderings and conceptual diagrams. A central logo with the letters 'L' and 'S' is prominently displayed.

Abstract

This poster features a large architectural rendering of a modern building with a curved facade and a glass facade. Below the rendering are several diagrams and charts, including a circular diagram with the letters 'L' and 'S' in the center. The text is organized into columns and sections, providing a detailed overview of the project's conceptual framework and design goals.

This poster displays architectural renderings of a building and surrounding landscape. It includes various diagrams and charts, such as a circular diagram with the letters 'L' and 'S' in the center. The text is organized into columns and sections, providing a detailed overview of the project's conceptual framework and design goals.

This poster displays architectural renderings of a building and surrounding landscape. It includes various diagrams and charts, such as a circular diagram with the letters 'L' and 'S' in the center. The text is organized into columns and sections, providing a detailed overview of the project's conceptual framework and design goals.

MASARIG: A Climate Change Induced Architectural Response through the Redevelopment of Bula Terminal Market

Abstract

In the Philippines, the agriculture sector is critical to both the country's economy and the people's well-being. As of 2018, around 10.9 million Filipinos work in the agriculture industry, accounting for 10% of national employment and contributing to approximately 10% of the Philippines' gross domestic product (GDP) (Palena, 2014). In addition, stakeholders have recognized the important role of the agriculture sector in increasing food availability and ensuring food security. However, the worsening conditions brought about by climate change have disrupted food production in agricultural areas including Bula, Camarines Sur. Bula's inherent vulnerability to climate change-induced risks, such as drought and flooding, is proven to be one of the causes of loss of livelihood, food insecurity, and low crop yield in the municipality (Food and Agriculture Organization of the United Nations, n.d.). Although farmers and fisherfolk have developed coping mechanisms—early planting, bamboo craft making, and utilizing alternative staples—, these have not brought significant change to their conditions due to the underlying issues of poor road networks and a lack of marketing support.

Framework

INHERENT VULNERABILITY

Climate Change Induced Risk (e.g., flooding, drought, etc.)

The flowchart illustrates the relationship between climate change induced risks (such as flooding and drought) and inherent vulnerability. It shows how these risks lead to food insecurity, which is further exacerbated by factors like poor road networks and lack of marketing support. The diagram includes boxes for 'Food Insecurity', 'Food Availability', and 'Food Security', with arrows indicating the flow of information and impact.

REDEVELOPMENT OF BULA TERMINAL MARKET

Market Modernization and Commercial Value, Public Transport System, Market Operational Status

User Profile

The User Profile section features six icons representing different groups: Workers, Stakeholder Groups, Students, Communities, Visitors, and Management Staff. Each icon is accompanied by a small text label.

User Behavior

The User Behavior section features four icons representing different activities: Shopping, Dining, Entertainment, and Recreation. Each icon is accompanied by a small text label.

Site Analysis

The Site Analysis section features six maps: Vegetation, Circulation, Land Use, Neighborhood Context, Population Flood Risk, and Traffic. Each map is accompanied by a small text label.

The poster concludes with a large architectural rendering of the Bula Terminal Market building, showing its modern design and integration with the surrounding landscape.



Integrating Urban Energy Systems into a Mixed-Use Urban Redevelopment

This panel features a large architectural rendering of a modern building complex situated along a waterfront with boats. A circular logo with stylized letters is centered on the image.

This panel displays a detailed site plan and architectural drawings, including floor plans and elevations. A circular logo with stylized letters is centered on the image.

BOCAUE+RIVER.

Revitalizing Culture, Heritage and Urban Form through an Innovative Urban Regeneration Process

This panel features a collage of images including a river scene, architectural renderings, and diagrams. A circular logo with stylized letters is centered on the image.



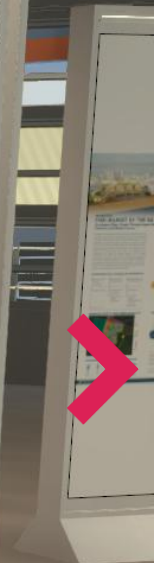
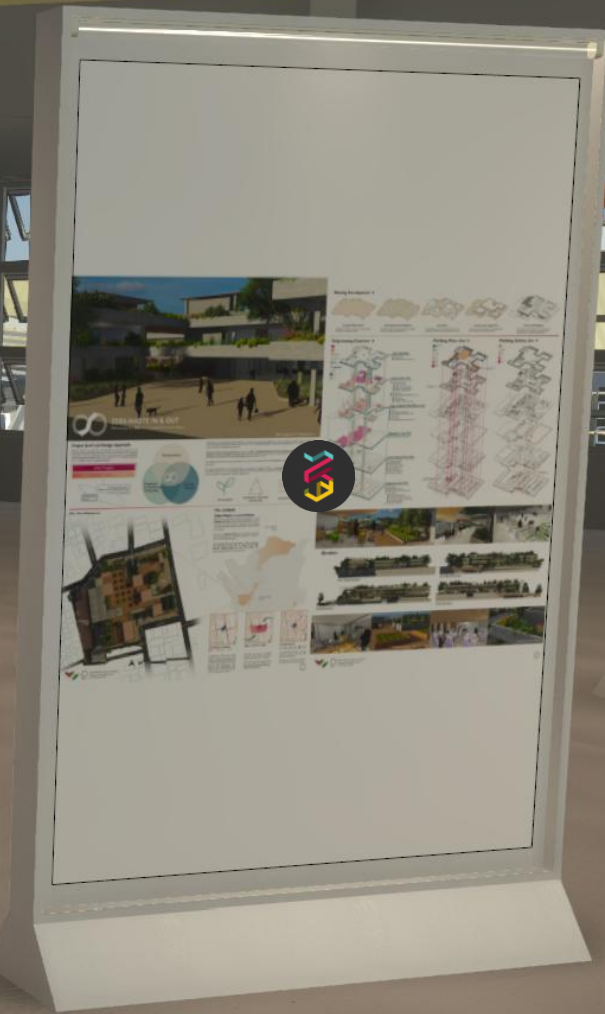



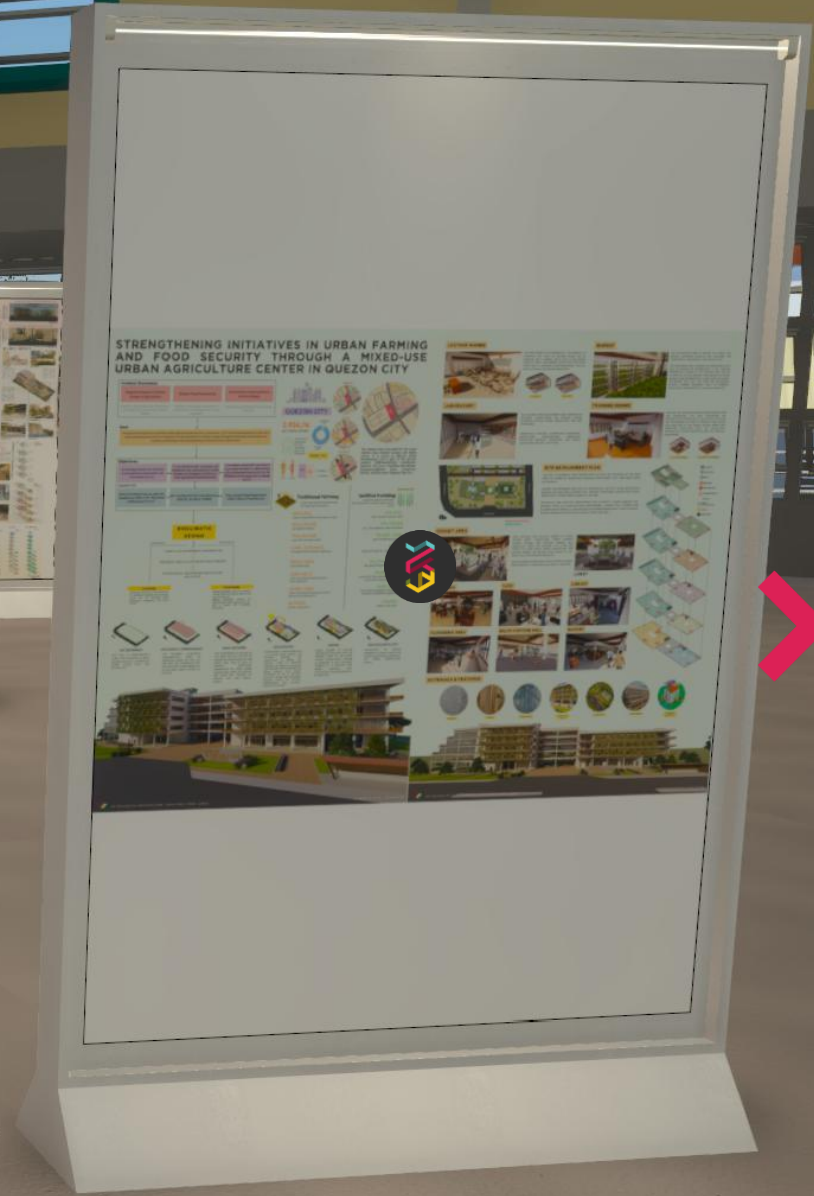

INTERWEAVING INDUSTRIES

This panel features two columns of architectural diagrams. The left column shows various site plans and floor plans with color-coded zones. The right column displays more detailed site plans and a vertical section of a building. A circular logo with a stylized 'L' and 'G' is positioned in the center.

This panel features a large central architectural rendering of a building with a prominent red-tiled roof. To the right of the rendering are several smaller diagrams, including a floor plan and a vertical section. A circular logo with a stylized 'L' and 'G' is positioned in the center.

This panel features a large central architectural rendering of a building with a prominent red-tiled roof. To the right of the rendering are several smaller diagrams, including a floor plan and a vertical section. A circular logo with a stylized 'L' and 'G' is positioned in the center.

RE/LOCATION

This panel is a comprehensive architectural presentation. It includes a large central rendering of a building with a prominent red-tiled roof. To the right of the rendering are several smaller diagrams, including a floor plan and a vertical section. A circular logo with a stylized 'L' and 'G' is positioned in the center.







LandESCAPE

CONCEPTUAL SITE PLAN

LANDSCAPE ARCHITECTURE

CONCEPT SPACE

LANDSCAPE ARCHITECTURE



LANDSCAPE ARCHITECTURE

CONCEPT SPACE

LANDSCAPE ARCHITECTURE



B LANDSCAPE ARCHITECTURE 4TH YEAR

L Arch 199 .2:
Thesis



LandESCAPE

BONIFACIO GLOBAL CITY

OUTDOOR ESCAPE ROOMS!

OBJECTIVES

ESCAPE ROOMS

METHODOLOGY

THEORIES AND CONCEPTS

CONCEPT: SPACE

SITE ANALYSIS

SITE DEVELOPMENT PLAN

MAKING PERSPECTIVES

ESCAPE ROOM PERSPECTIVES

SKY SCENES

LandESCAPE

FINDINGS AND ANALYSIS

SYNTHESIS

THE STUDY SITES

RECOMMENDATIONS: SHADE TREE LAYOUT GUIDELINES FOR COOLING

SHADE LANDSCAPE FOR EFFICIENT BUILDING AIR-CONDITIONING: TREE LAYOUT GUIDELINES FOR THE THREE U.P. DULAMAN BUILDING UNITS

BACKGROUND OF THE STUDY

RESEARCH FRAMEWORK

PROBLEM SETTING

PROBLEM STATEMENT

GOAL OF THE STUDY

OBJECTIVES

SHADE LANDSCAPE FOR EFFICIENT BUILDING AIR-CONDITIONING: TREE LAYOUT GUIDELINES FOR THE THREE U.P. DULAMAN BUILDING UNITS



