

● L Arch 12: *Community Parks*

● Arch 3: *Advanced Rendering and Graphic Layout*

● CWTS: *Community Proposal*

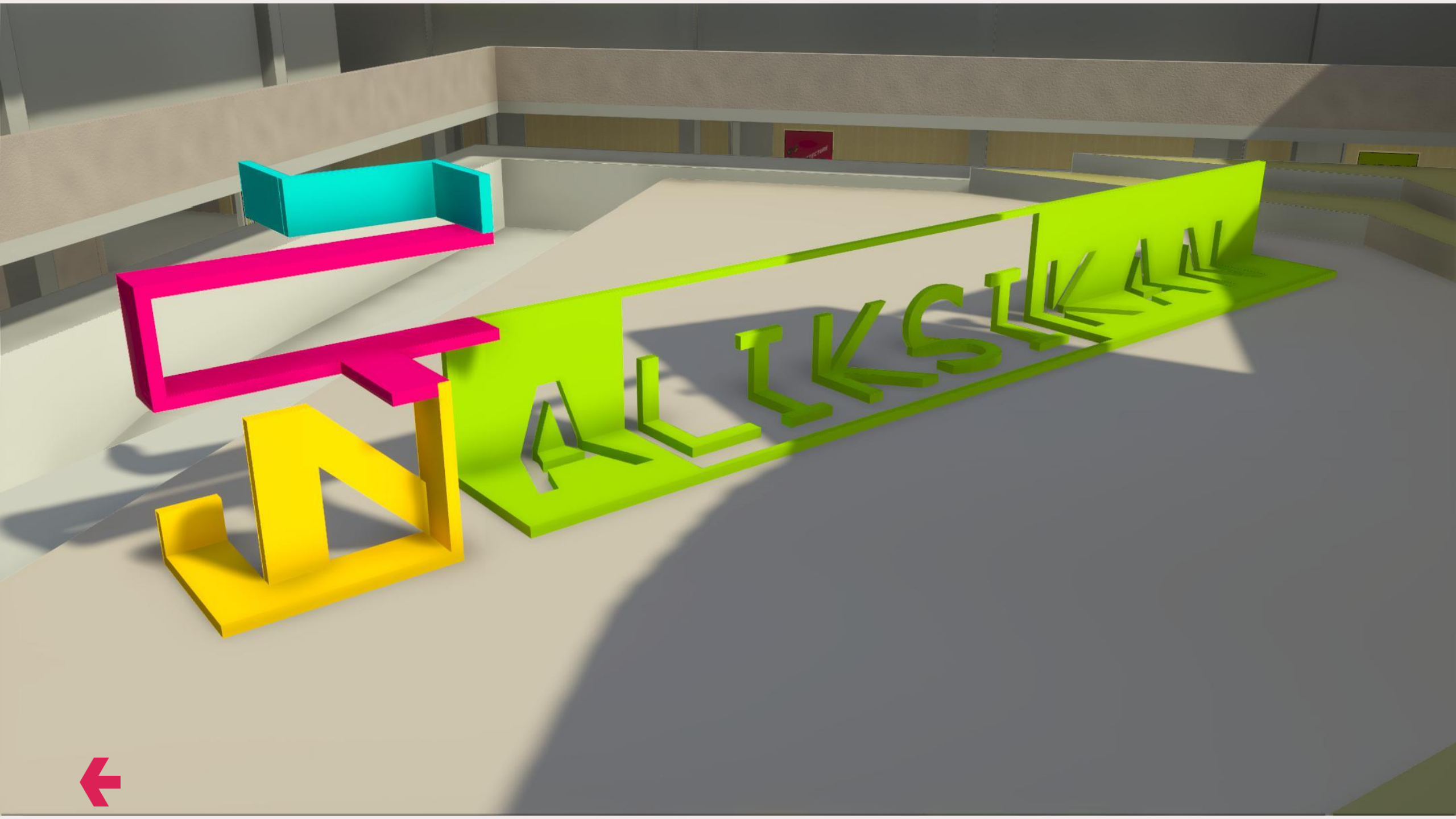





FLOOR DIRECTORY OF DISPLAYS

Building 1

LOWER GROUND

● BS Architecture

Arch 31: UP Shopping Center

Arch 32: Multi-family Housing Project

3 Arch 171: Banana Crane

Arch 142: Metropolitan Architecture

Arch 143: Acoustics

Arch 147: Lighting

4 Arch 162: Metropolitan Structure Plans and Vision Boards

● B Landscape Architecture

L Arch 132: Protected Area Landscape Design

L Arch 132: Botanical Park Landscape Design

L Arch 132: Mini-Thesis

L Arch 138: Protected Area Management through GIS Technologies

SECOND FLOOR

● BS Architecture

5 Arch 199.2: Thesis

● B Landscape Architecture

L Arch 199.2: Thesis

4 L Arch 208: Thesis

Building 2

UPPER GROUND

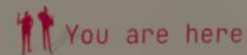

LOWER GROUND

● BS Architecture

Arch 5: High-End Two-Storey Residential Project

Arch 22: Maginhawa Landmark Hub

Arch 22: UP Diliman Students' Wellness Center

● B Landscape Architecture

2 L Arch 22: Kalinga Daycare Center

Bridge Area

● M Architecture

Arch 308: Thesis

● PhD Designed and Built Environment

DBE 397

● MA in Architecture Studies

Archi 299





FLOOR DIRECTORY OF DISPLAYS

Building 1

LOWER GROUND

● BS Architecture

- Arch 31: UP Shopping Center
- Arch 32: Multi-family Housing Project
- 3 Arch 171: Banana Crane
- Arch 142: Metropolitan Architecture
- Arch 143: Acoustics
- Arch 147: Lighting
- 4 Arch 142: Metropolitan Structure Plans and Vision Boards

● B Landscape Architecture

- L Arch 132: Protected Area Landscape Design
- L Arch 132: Botanical Park Landscape Design
- L Arch 132: Mini-Thesis
- L Arch 138: Protected Area Management through GIS Technologies
- 3

SECOND FLOOR

● BS Architecture

- 8 Arch 199.2: Thesis

● B Landscape Architecture

- L Arch 199.2: Thesis
- 4 L Arch 200: Thesis

Building 2

UPPER GROUND

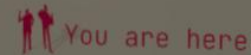

LOWER GROUND

● BS Architecture

- Arch 5: High-End Two-Storey Residential Project
- Arch 22: Maginhawa Landmark Hub
- 2 Arch 22: UP Diliman Students' Wellness Center

● B Landscape Architecture

- 2 L Arch 22: Kalinga Daycare Center

Bridge Area

● M Architecture

- Arch 300: Thesis

● PhD Designed and Built Environment

- DBE 397

● MA in Architecture Studies

- Archi 299



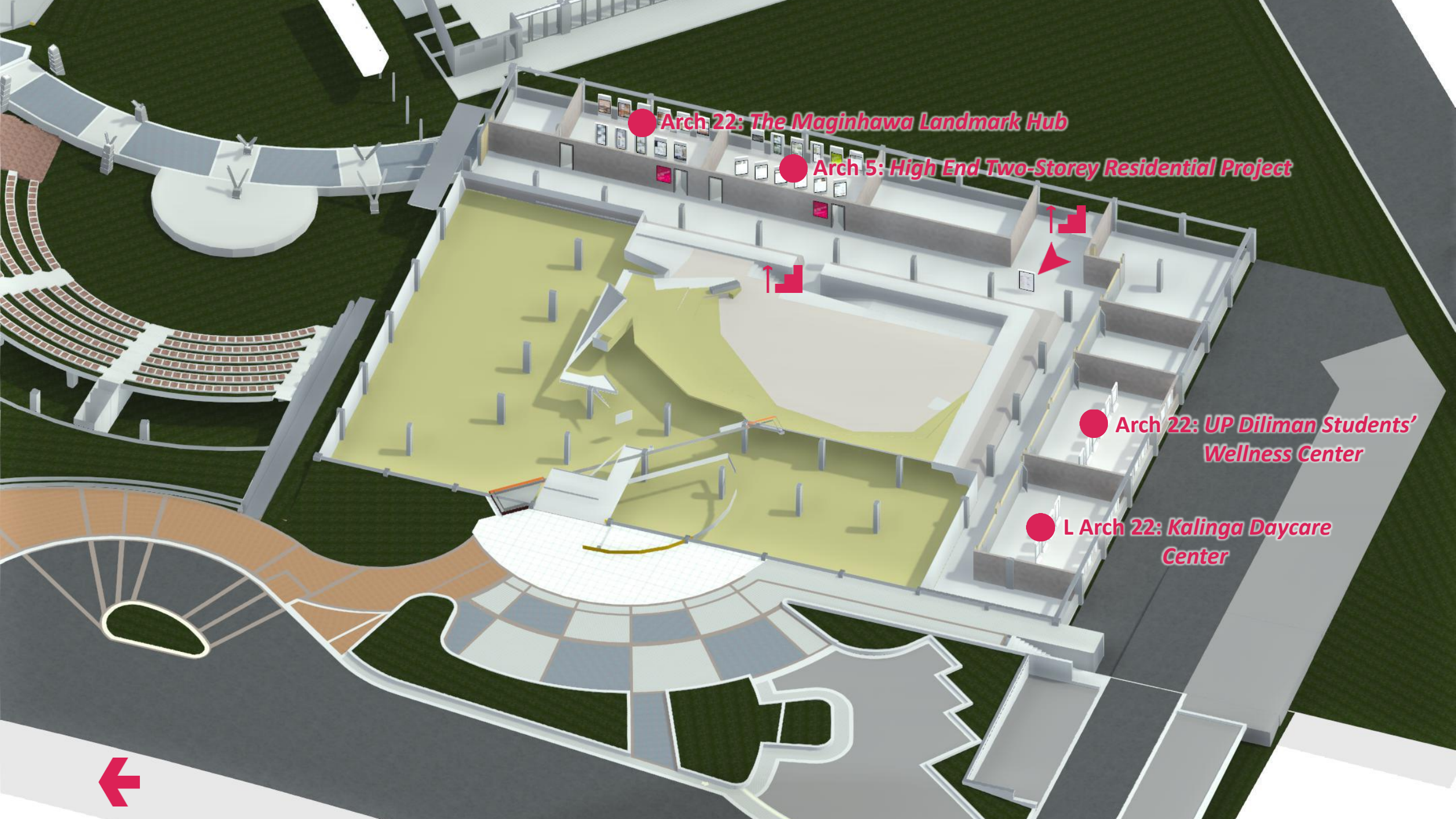

● Arch 22: The Maginhawa Landmark Hub

● Arch 5: High End Two-Storey Residential Project

● Arch 22: UP Diliman Students' Wellness Center

● L Arch 22: Kalinga Daycare Center





FLOOR DIRECTORY OF DISPLAYS

Building 1

LOWER GROUND

● BS Architecture

Arch 31: UP Shopping Center
Arch 32: Multi-family Housing Project

3 Arch 171: Banana Crane

Arch 142: Metropolitan Architecture

Arch 143: Acoustics

Arch 147: Lighting

4 Arch 162: Metropolitan Structure Plans and Vision Boards

● B Landscape Architecture

L Arch 132: Protected Area Landscape Design

L Arch 132: Botanical Park Landscape Design

L Arch 132: Mini-Thesis

3 L Arch 138: Protected Area Management through GIS Technologies

SECOND FLOOR

● BS Architecture

5 Arch 199.2: Thesis

● B Landscape Architecture

L Arch 199.2: Thesis

4 L Arch 288: Thesis

Building 2

UPPER GROUND

● BS Architecture

1 Arch 3: Advanced Rendering and Graphic Layout

● B Landscape Architecture

1 L Arch 12: Community Park

● CWTS

CWTS 2: Community Proposal

LOWER GROUND

 You are here

Bridge Area

● M Architecture

Arch 388: Thesis

● PhD Designed and Built Environment

DBE 397

● MA in Architecture Studies

Archi 299





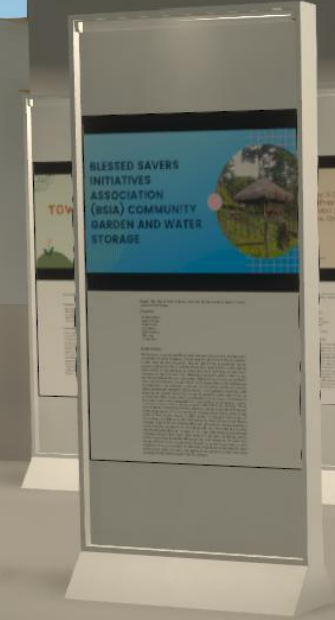

Our Proposal

LINIS LANGYAW: A COMMUNITY WASTE MANAGEMENT PROJECT

WASTE MANAGEMENT FACILITY



Project Title: LINIS LANGYAW - A Community Waste Management Project - Final Report and Project Deliverables

Proposer:
 Veronica Escobar, J. Garcia
 Charis Mae B. Dabla-Buena
 The Christian's Choice
 Manila South City
 Manila, Philippines
 November 2022

Project Overview:
 The community project proposal, Linis Langyaw, is a sustainable waste management project specifically designed to address the waste management and disposal issues plaguing the community of Langyaw and surrounding surrounding barangay and general management concerns in the community. The initiative involves building and general upgrading of the waste, and also lack of the necessary and existing facilities for community members and the staff providing care. Through the development of a waste management facility, the project aims to address these issues through the installation of a waste management facility in the community. The project will be implemented as follows: site selection, land acquisition, and construction of the waste management facility. It is expected to see that the implementation of the project leads to a more organized, safe, and healthy community in Langyaw.

TOWER GARDENS SAJUSSA

Project Title: Tower Gardens Sajussa Initiative - Final Report and Project Deliverables

Proposer:
 Veronica Escobar, J. Garcia
 Charis Mae B. Dabla-Buena
 The Christian's Choice
 Manila South City
 Manila, Philippines
 November 2022

BLESSED SAVERS INITIATIVES ASSOCIATION (BSIA) COMMUNITY GARDEN AND WATER STORAGE



Project Title: Blessed Savers Initiative Association (BSIA) Community Garden, Water Storage and Food Storage

Proposer:
 Veronica Escobar, J. Garcia
 Charis Mae B. Dabla-Buena
 The Christian's Choice
 Manila South City
 Manila, Philippines
 November 2022

SITIO MAHAYAG ALLIANCE OF STRUCTURE HOMEOWNERS ASSOCIATION INC. (SMASH)



Project Title: Sitio Mahayag Alliance of Structure Homeowners Association Inc. (SMASH) - Final Report and Project Deliverables

Proposer:
 Veronica Escobar, J. Garcia
 Charis Mae B. Dabla-Buena
 The Christian's Choice
 Manila South City
 Manila, Philippines
 November 2022

Agaw-Agaw Group



Project Title: DEVELOPING A SPACE AND ENERGY-EFFICIENT COMMUNITY KITCHEN FOR THE AGAW-AGAW COMMUNITY

Proposer:
 Alonzo Apdon
 Falcon Mejia
 No. 10
 T. 1

Project Overview:
 As stated through the focus group discussions (FGDs) both members of the Agaw-Agaw community are primarily composed of low-income families that have experienced food insecurity on an almost regular basis, with those people having had no access to food as well as access for preparing meals, and as a result, rely heavily on purchasing food elsewhere, or so. The said group proposes a project that aims to do particular need through the development of a community kitchen. This will improve their lives by providing them access to the immediate basic needs, as in home-cooked food, as well as allowing them to develop their skills in food handling. The facility will also increase the physical and social cohesion of the community by providing a safe and clean eating area; space that will foster and continuously provide a safe and clean eating area; space that will foster and continuously provide a safe and clean eating area; space that will foster and continuously provide a safe and clean eating area.





BS ARCHITECTURE

1ST YEAR



Arch 3: Advanced Rendering and Graphic Layout

CONCRETE HEIGHTS

CONCRETE HEIGHTS

CROSS SECTION



Hillside Farm Renovation

DESIGN PROPOSAL

MAIN ELEMENTS

LANDSCAPE DESIGN

FRONT ELEVATION

REAR ELEVATION

Orange Hills

LANDSCAPE DESIGN

22222 1ST BERTHOUSE COMPLEX

CONCEPT

SECTION

ELEVATION

FRONT ELEVATION

REAR ELEVATION

HARBOR IN THE SKY

CONCEPT

SECTION

ELEVATION

CONCRETE HEIGHTS

RESIDENTIAL HOUSE

SITE DEVELOPMENT PLAN

GROUND FLOOR PLAN

CONCEPT

CONCRETE HEIGHTS

ELEVATIONS

CROSS SECTION

CASA DE VERANO
 COUNTRY HOME ON THE ISLAND

SITE DEVELOPMENT PLAN

SECOND FLOOR PLAN

ELEVATION

ELEVATION

ELEVATION

ELEVATION



CASA DE VERANO
 COUNTRY HOME ON THE ISLAND

CASA DE VERANO
 COUNTRY HOME ON THE ISLAND

URBAN SANCTUARY

LANDSCAPE ARCHITECTURE



Serenity House

LANDSCAPE ARCHITECTURE

Hillside Farm

DESIGN PROGRAM

LANDSCAPE ARCHITECTURE



CASA DE VERANO

SUMMER HOME ON THE ISLAND

SEE THE BEAUTIFUL VIEW
The design of the house highlights the beautiful view of the surrounding landscape. In the house, the design is to offer the best view looking out to the ocean or the island. The house is designed to be a summer home on the island.

GET TO HIGHER GROUND
The primary levels are elevated to higher ground. The house is designed to be a summer home on the island. The house is designed to be a summer home on the island.

CONNECT WITH NATURE
The site and land were used to create a connection with nature. The house is designed to be a summer home on the island. The house is designed to be a summer home on the island.

CASA DE VERANO

SUMMER HOME ON THE ISLAND

COMFORTABLE INTERIOR
The interior is designed to be comfortable and enjoyable. The house is designed to be a summer home on the island. The house is designed to be a summer home on the island.

BREATHING MODERNITY
The house is designed to be modern and enjoyable. The house is designed to be a summer home on the island. The house is designed to be a summer home on the island.

NATURAL + MODERN
The house is designed to be natural and modern. The house is designed to be a summer home on the island. The house is designed to be a summer home on the island.

Mirage Hills

Extraordinarily beautiful, it glitters and it twinkles. A ray of hope of beauty, and of necessity.

A Mirage
Mirage Hills aim to give the necessary beauty to human lives. It is a vacation home that acts as a refuge from the busy urban life and to look in the loveless of nature. Designed to cater to people of all ages, it is the best place for everyone in the family!

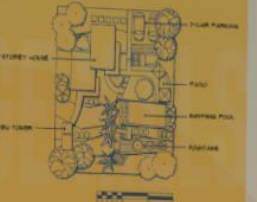

SITE DEVELOPMENT PLAN



Breaking the grassy fields, Mirage Hills provides a great outdoor place for bonding and recreation with your family and friends. The outdoors can be used for parties, for camping, for leisure walks, and many more!



It is located at a quiet and private hill and is designed to be enjoyed either in tranquility or high-energy activities!



Serenity House

...



...



...



...



 **B LANDSCAPE ARCHITECTURE** 
1ST YEAR

L Arch 12:
Community Park



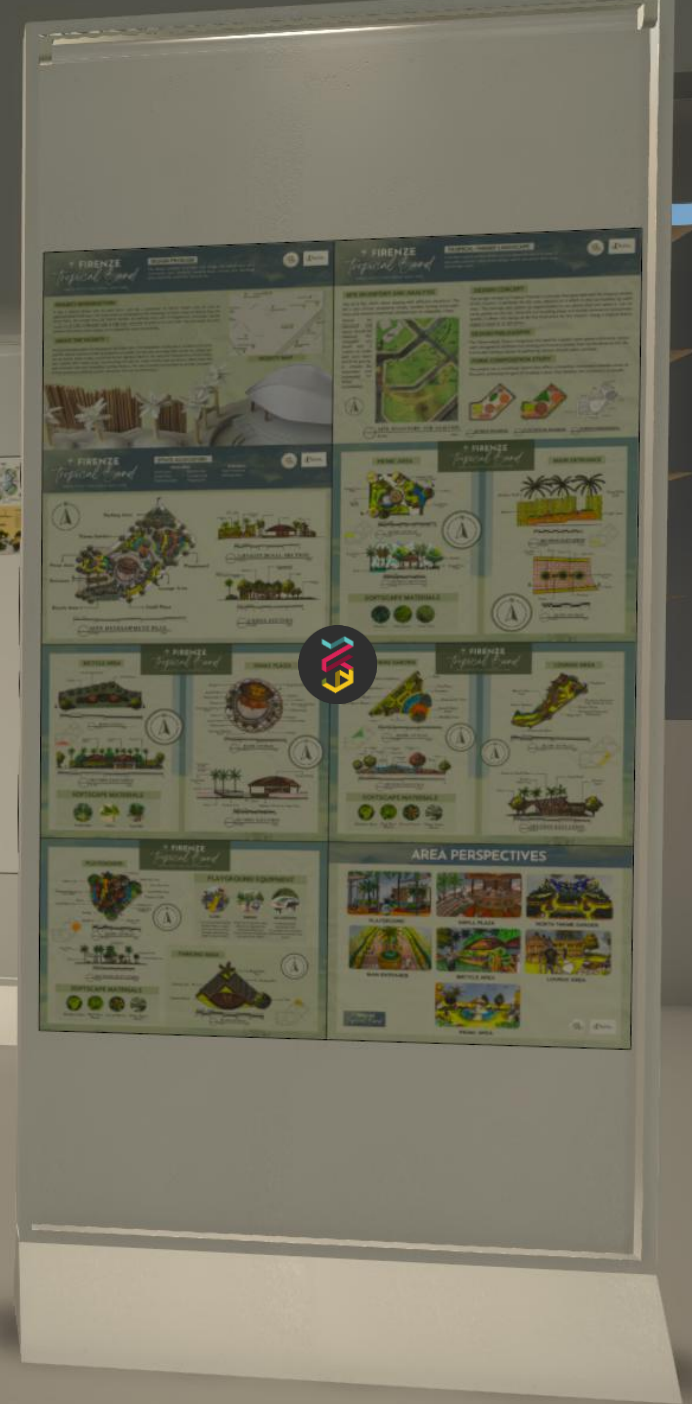

BELTON PARK
Architectural site plan for Belton Park, featuring various zones and landscaping details.

BELTON PARK
Architectural site plan for Belton Park, showing a different section of the park layout.

PLAZA
Architectural site plan for a plaza area, including seating and walkway designs.

PERIPHERY
Architectural site plan for the periphery area, detailing boundary zones and access points.

PLAYGROUND
Architectural site plan for a playground area, showing play equipment and safety zones.

BOONDOCKS DESIGN CO.
Professional information for Boondocks Design Co., including contact details and team members.



Hi-Ground Community Park
Architectural site plan for Hi-Ground Community Park, detailing various zones and landscaping.

Site Boundary and Site Analysis
Site Boundary and Site Analysis section.

Design Concept
Design Concept section.

The Plateau
The Plateau section.

Pantry
Pantry section.

The Valley
The Valley section.

Backyard
Backyard section.

The Base
The Base section.



Park
Architectural site plan for a park area, showing various zones and landscaping details.





BS ARCHITECTURE
2ND YEAR



BS ARCHITECTURE 2ND YEAR

Arch 221
UP Diliman Students'
Wellness Center





Yakap

UP Student Wellness Center

Through its design, the UP Wellness Center aims to evoke a sense of comfort and belongingness for the University's students. Here, they can find refuge and recharge, hangout with friends or catch up on studies. It takes the form of an acacia tree, an icon famous associated with the campus whose branches seem to intertwine with one another, reaching out to the beside it and providing shade for those under it.



1st Floor Plan

2nd Floor Plan



Front Elevation

Left Elevation



- Spaces:
1. Student Commons
 2. Multipurpose Rooms
 3. UP Center for Mental Wellbeing
 4. Park
 5. Food seating
 6. Parking (bicycles and cars)

Features:



Gillian Go | Arch 22 AY 21-22

HIRASOL

THE UP DILMAN STUDENTS' WELLNESS CENTER
BY CZARINA ELANE B. MENDOZA

CONCEPT

The UP Diliman campus is a well-known landmark. The wellness center is designed to be a landmark in its own right, providing a space for students to relax and rejuvenate. The building is designed to be a landmark in its own right, providing a space for students to relax and rejuvenate.

GROUND FLOOR PLAN

SITE DEVELOPMENT PLAN

1. MAIN LOBBY
2. BIOPARC
3. YOGA ROOM
4. GYM
5. MASSAGE CHAIRS
6. VEGETABLE GARDEN

SECOND FLOOR PLAN

ELEVATIONS

HIRASOL
THE UP DILMAN STUDENTS' WELLNESS CENTER

MAIN LOBBY

YOGA ROOM

GYM

VEGETABLE GARDEN

MASSAGE CHAIRS

BIOPARC

PERSPECTIVES
BY CZARINA ELANE B. MENDOZA

Kalinga

The UP Diliman Wellness Center

GENERAL RESERVATION

FEATURES:

- LANDSCAPE
- BIOPARC
- VEGETABLE GARDEN
- YOGA ROOM
- GYM
- MASSAGE CHAIRS

GROUND FLOOR PLAN

SECOND FLOOR PLAN

RIGHT ELEVATION

FRONT ELEVATION

LEFT ELEVATION

EXTERIOR PERSPECTIVE

INTERIOR PERSPECTIVES

Chrysalis

WELLNESS CENTER

CONCEPT

The UP Diliman campus is a well-known landmark. The wellness center is designed to be a landmark in its own right, providing a space for students to relax and rejuvenate. The building is designed to be a landmark in its own right, providing a space for students to relax and rejuvenate.

GROUND FLOOR PLAN

SECOND FLOOR PLAN

ELEVATIONS

EXTERIOR PERSPECTIVE

INTERIOR PERSPECTIVES

ESPASO
The UP Diliman Wellness Center

CHRYSLIS WELLNESS CENTER

UP Diliman

THE MAGNIFICENT LANDMARK

CONCEPT

The UP Diliman campus is a well-known landmark. The wellness center is designed to be a landmark in its own right, providing a space for students to relax and rejuvenate. The building is designed to be a landmark in its own right, providing a space for students to relax and rejuvenate.

GROUND FLOOR PLAN

SECOND FLOOR PLAN

ELEVATIONS

EXTERIOR PERSPECTIVE

INTERIOR PERSPECTIVES

DILMAN

THE UP DILMAN STUDENTS' WELLNESS CENTER

CONCEPT

The UP Diliman campus is a well-known landmark. The wellness center is designed to be a landmark in its own right, providing a space for students to relax and rejuvenate. The building is designed to be a landmark in its own right, providing a space for students to relax and rejuvenate.

GROUND FLOOR PLAN

SECOND FLOOR PLAN

ELEVATIONS

EXTERIOR PERSPECTIVE

INTERIOR PERSPECTIVES

ESPASO

The UP Diliman Wellness Center

CONCEPT

The UP Diliman campus is a well-known landmark. The wellness center is designed to be a landmark in its own right, providing a space for students to relax and rejuvenate. The building is designed to be a landmark in its own right, providing a space for students to relax and rejuvenate.

GROUND FLOOR PLAN

SECOND FLOOR PLAN

ELEVATIONS

EXTERIOR PERSPECTIVE

INTERIOR PERSPECTIVES



aninag

RENDERING OF THE PROPOSED REVISIONS TO THE DESIGN

EXTERIOR PERSPECTIVE

INTERIOR PERSPECTIVE

baliki

KAULAYAW

KAULAYAW

THE UP DILIMAN STUDENTS' WELLNESS CENTER

UP Diliman Students' Wellness Center

GF

2F

EXTERIOR PERSPECTIVES

GROUND FLOOR

SECOND FLOOR





8 LANDSCAPE ARCHITECTURE 2ND YEAR



B LANDSCAPE ARCHITECTURE 2ND YEAR



L Arch 22:
KaLinga Daycare Center

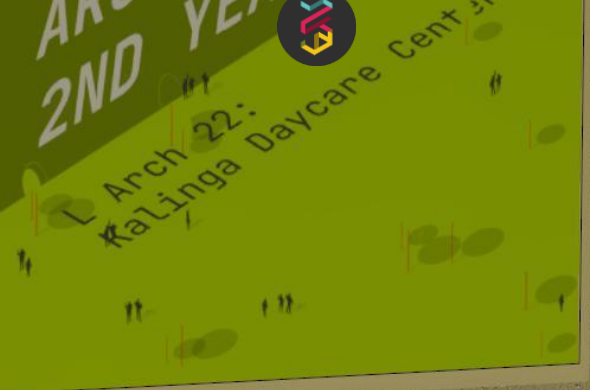

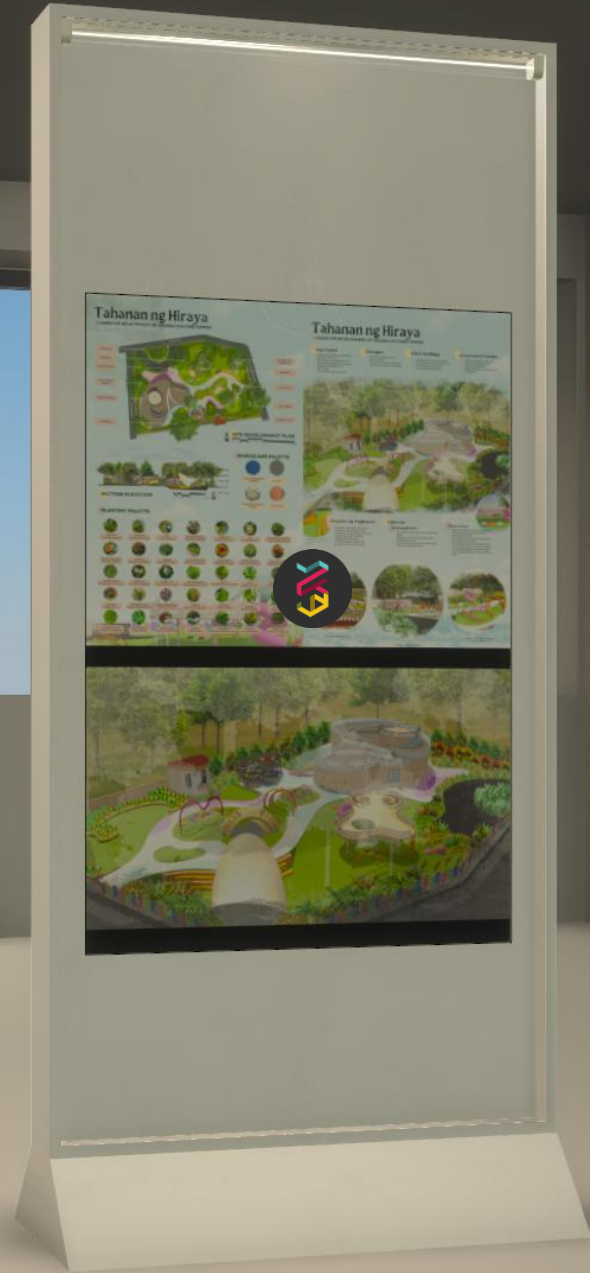



HIVE SITE DEVELOPMENT PLAN

HIVE An Interactive Learning Playground to be #FreeAsAbee

DESIGN CONCEPT

PERSPECTIVES

LANDSCAPE FEATURES

THE HIVE: An Interactive Learning Playground to be #FreeAsAbee

LA 22 LANDSCAPE DESIGN IV

HIVE An Interactive Learning Playground to be #FreeAsAbee

AN INTERACTIVE LEARNING PLAYGROUND TO BE #FREEASABEE

PROJECT BACKGROUND

The idea for this project was conceived in a context where the city of Los Angeles is striving for inclusivity of the population through public space. This site is located in the heart of the city and is a prime area for the city to create a public space that is both a playground and a learning center.

The Proposed HIVE Development Area is 2,000 SQM.

DESIGN CONCEPT

In the early stages of the design process, the goal was to create a space that is both a playground and a learning center. The design concept is based on the idea of a "hive" and is intended to be a place where children can learn about bees and the environment while playing.

The design concept for this site was based on the idea of a "hive" and is intended to be a place where children can learn about bees and the environment while playing. The design concept is based on the idea of a "hive" and is intended to be a place where children can learn about bees and the environment while playing.

FORM FINDING

To create an open, playful, and educational environment for the HIVE, a series of interconnected forms were developed. These forms are designed to be both functional and aesthetically pleasing, and are intended to be a place where children can learn about bees and the environment while playing.

LANDSCAPE FEATURES

THE HONEY TRAIL

This trail is a series of interconnected forms that are designed to be both functional and aesthetically pleasing. The trail is intended to be a place where children can learn about bees and the environment while playing.

THE HIVE: An Interactive Learning Playground to be #FreeAsAbee

LA 22 LANDSCAPE DESIGN IV

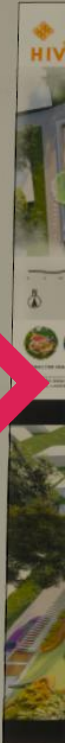

ADDITIONAL PERSPECTIVES

ARCHITECT: RICKY JI, CHRIS, LINDA, TUPAN

KINDER BLOCKS

LANDSCAPE ARCHITECTURE

kinderblocks

DESIGN PROPOSAL FOR THE KALINGA DAYCARE CENTER COMPLEX

SITE ANALYSIS

KID'S NEEDS DESIGN CONCEPT AND PRINCIPLES
LEGO BLOCKS

DESIGN PROCESS

SITE DEVELOPMENT PLAN

MY IDEAS

CONDUCTED ANALYSIS

PLANT PALETTE

LANDSCAPE PALETTE







E 101 HOUSE

Architectural drawings for the E 101 House, including site plans and floor plans.

HIGH-END TWO-STORY RESIDENTIAL PROJECT

Architectural drawings for a high-end two-story residential project, including site plans, floor plans, and elevations.



HOME AD ASTRA*

Architectural drawings for Home Ad Astra, including site plans, floor plans, and elevations.



HIGH-END TWO-STORY RESIDENTIAL HOUSE

Architectural drawings for a high-end two-story residential house, including site plans, floor plans, elevations, and interior renderings.



KANTO

Architectural presentation board for 'KANTO'. It features a central image of a modern house with a large porch and a gabled roof. Surrounding this are various architectural drawings, including floor plans, elevations, and sections. A circular logo with stylized letters is visible in the center of the board.

HILL CREST

Architectural presentation board for 'HILL CREST'. It features a central image of a house with a prominent chimney and a gabled roof. Surrounding this are various architectural drawings, including floor plans, elevations, and sections. A circular logo with stylized letters is visible in the center of the board.

THE 121 HOUSE

By GLENN WELLS

Architectural presentation board for 'THE 121 HOUSE'. It features a central image of a house with a wide overhanging roof and a gabled roof. Surrounding this are various architectural drawings, including floor plans, elevations, and sections. A circular logo with stylized letters is visible in the center of the board.

TWO-STORY LANDSCAPE

Architectural presentation board for 'TWO-STORY LANDSCAPE'. It features a central image of a house with a gabled roof and a prominent chimney. Surrounding this are various architectural drawings, including floor plans, elevations, and sections. A circular logo with stylized letters is visible in the center of the board.



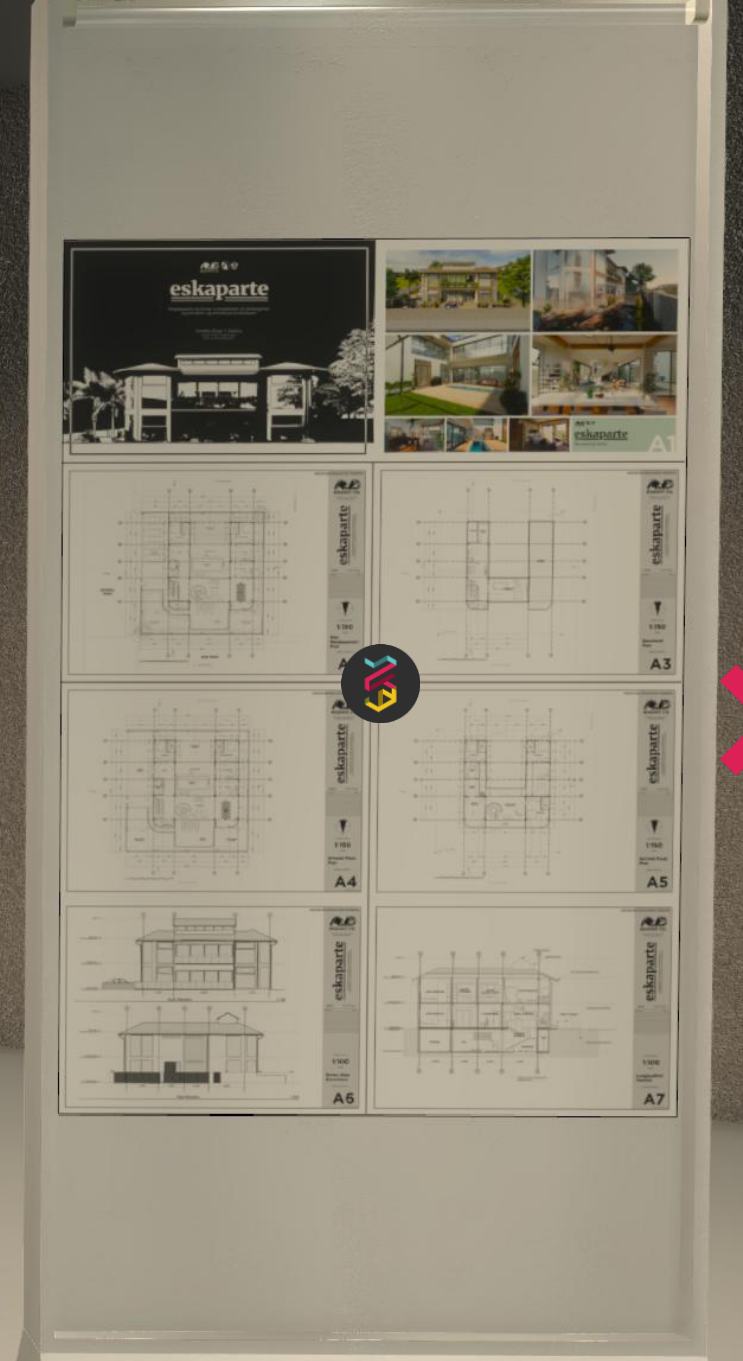

HIKARI: SIMPLE & CLEAN TWO-STORY RESIDENTIAL TOWNHOUSE



HIKARI: SIMPLE & CLEAN TWO-STORY RESIDENTIAL TOWNHOUSE



B. LANDSCAPE ARCHITECTURE 3RD YEAR

TWO-STORY MODERN VILLA



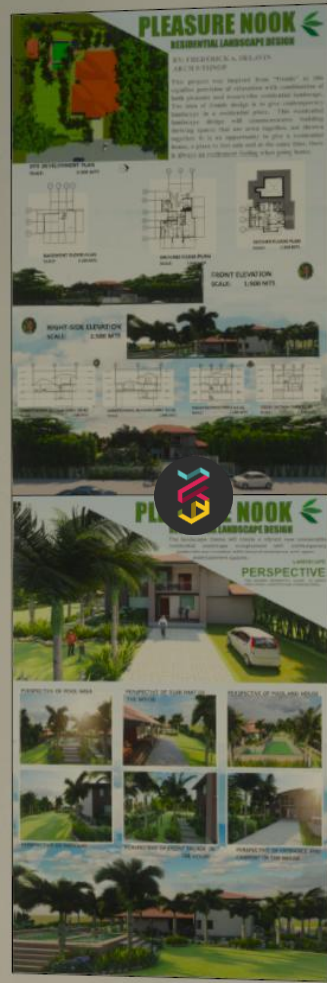





Maginhawa Community Plaza

John A. Clark
MOE 21 Final Stage

Architectural drawings, site plan, and a 3D rendering of the Maginhawa Community Plaza building.

THE LIWANAG HUB

THE SITE

ASSESSMENT & VISIBILITY

THE CONCEPT

THE TYPICAL STOREY

THE TYPICAL COLLECTIVE

PHASIS

WESTER

ASSESSMENT & VISIBILITY

Architectural drawings, site plan, and a 3D rendering of The Liwanag Hub building.

lacuna

THE MAGINHAWA LANDMARK HUB

Jan Abigail Alamo | Arch 22 Final Plate

Architectural drawings, site plan, and a 3D rendering of the lacuna building.

GROUND FLOOR PLAN WITH SITE DEVELOPMENT PLAN

SECOND FLOOR PLAN

- 01. WAITING AREA/OUTDOOR EVENT SPACE
- 02. CAR PARKING
- 03. BICYCLE PARKING
- 04. TERRACE
- 05. OPEN EVENT SPACE
- 06. STORAGE
- 07. RESTROOM
- 08. LOUNGE
- 09. OFFICE
- 10. INDOOR SEAT SPACE/STREET VIEW

THE TERRACES

maginhawa street's food court

The building aims to be a multi-use structure, a mix of residential, commercial, and public spaces, all integrated with sustainable design.

concept

site development

isometric view

ground floor

the ground floor features the entrance, office, and a large dining area with a central stage.

second floor

the second floor features the office, residential units, and a parking area.

third floor

the third floor features the residential units, a rooftop garden, and a parking area.

elevations

roof

sections

ORASODE: The Maginhawa landmark Hub

DESCRIPTION

ORASODE is a multi-use landmark development located along Maginhawa Street. The building is a mix of residential, commercial, and public spaces, all integrated with sustainable design.

DESIGN CONCEPT PERSPECTIVE

The design concept is based on the idea of a landmark building that serves as a hub for the community. The building is designed to be a mix of residential, commercial, and public spaces, all integrated with sustainable design.

SITE DEVELOPMENT PLAN

LEVEL FLOOR PLANS

SECTION VIEWS

Rosas Complex

JURIA, Oliver Jason D.

Design Problem

Design Solution

Design Elements:
 Blazing Opening
 Centralized Asymmetry
 Outside Pooling
 Biophilic

Roofs
Ground Floor Interiors
Second Floor Interiors
Ground Floor Interiors

Ground Floor Plans
Second Floor Plans

Longitudinal Section
Cross Sections
Longitudinal Section

Left Elevation
Right Elevation
Rear Elevation
Left Elevation
Right Elevation

Front Elevation

Open Area
Event Space
Site Normal Perspective

ROSA'S COMPLEX
 OLIVER JASON D. JURIA

Dance Studio
Gym Area

A grid of architectural renderings and diagrams for the Rosas Complex. The top row shows exterior elevations of the building. The middle section contains various interior renderings of different spaces, including a lounge area, a dance studio, and a gym. The bottom row shows more exterior views and site plans. A circular logo is overlaid on the center of the grid.



HABI

HABI

Architectural drawings for the HABI project, including site plans, floor plans, and elevations. A circular logo with stylized letters is visible in the bottom right corner of this section.



DESIGN CONCEPT LUMAGI

DESIGN CONCEPT LUMAGI

Collage of architectural drawings and renderings for the LUMAGI project, including site plans, floor plans, and elevations. A circular logo with stylized letters is visible in the bottom right corner of this section.

final plate:
THE MAGINHAWA
LANDMARK HUB



- to remain -
the memories and the hope within

PRESENTATION BY: SHERINAH SUELTO

KAPWA COMMUNITY FARMERS MARKET

Architectural drawings and renderings for the KAPWA Community Farmers Market, including site plans, floor plans, and elevations. A circular logo with stylized letters is visible in the bottom right corner of this section.

